

Syphons

WS, LWS and UWS Series



Features

- Maximum working temperature: 850 °F (454 °C).
- Working pressure up to: 6000 psig (414 bar). Multiply the working pressure by the elevated temperature factors to get the working pressure at elevated temperature. To locate the elevated temperature factor, please refer to the FITOK catalog for **Tubing**.
- Standard materials are 316 SS and 304 SS, other materials are available upon request.

Material Specifications

Component	Material
Tube	316/316L or 304/304L
Connector	316 or 304

Types and Dimensions

Dimensions are in mm unless otherwise specified. They are for reference only and are subject to change.

WS Series

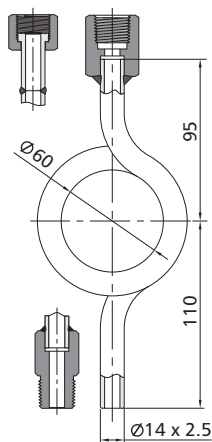

LWS Series

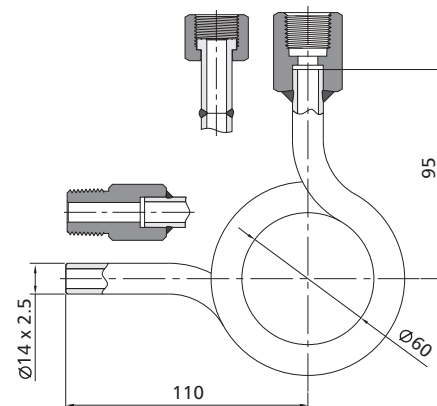

UWS Series

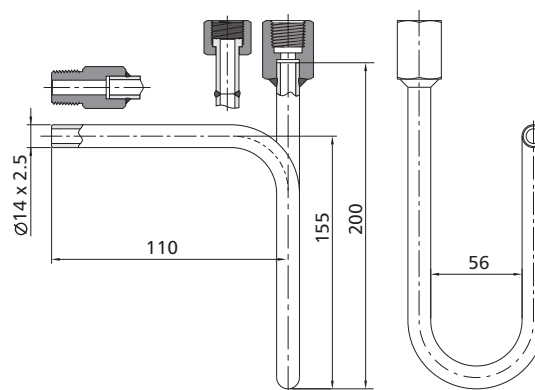

Ordering Information

Add the material designator as prefix to the basic ordering number (SS for 316 SS, S4 for 304 SS).

Example: **SS-WS-MTB14-T**

End Types and Size		Basic Ordering Number		
Cock End	Process End	WS Series	LWS Series	UWS Series
1/2 Female NPT	1/2 Female NPT	-WS-FNS8	-LWS-FNS8	-UWS-FNS8
1/2 Female NPT	1/4 Female NPT	-WS-FNS8-FNS4	-LWS-FNS8-FNS4	-UWS-FNS8-FNS4
1/2 Female NPT	1/2 Female ISO Parallel Thread	-WS-FNS8-RG8	-LWS-FNS8-RG8	-UWS-FNS8-RG8
1/2 Female NPT	1/4 Female ISO Parallel Thread	-WS-FNS8-RG4	-LWS-FNS8-RG4	-UWS-FNS8-RG4
1/2 Female NPT	M20 x 1.5 Female ISO	-WS-FNS8-MG20	-LWS-FNS8-MG20	-UWS-FNS8-MG20
1/2 Female NPT	M14 x 1.5 Female ISO	-WS-FNS8-MG14	-LWS-FNS8-MG14	-UWS-FNS8-MG14
1/2 Female NPT	1/2 Tube Socket Weld	-WS-FNS8-TS8	-LWS-FNS8-TS8	-UWS-FNS8-TS8
1/2 Female NPT	14 mm Tube Socket Weld	-WS-FNS8-MTS14	-LWS-FNS8-MTS14	-UWS-FNS8-MTS14
M20 x 1.5 Female ISO	M20 x 1.5 Female ISO	-WS-MG20	-LWS-MG20	-UWS-MG20
M20 x 1.5 Female ISO	M14 x 1.5 Female ISO	-WS-MG20-MG14	-LWS-MG20-MG14	-UWS-MG20-MG14
M20 x 1.5 Female ISO	Ø 14 x 2.5	-WS-MG20-MTB14	-LWS-MG20-MTB14	-UWS-MG20-MTB14
Rotating M20 x 1.5 Female ISO	M20 x 1.5 Female ISO	-WS-RMG20-MG20	-LWS-RMG20-MG20	-UWS-RMG20-MG20
Rotating M20 x 1.5 Female ISO	M14 x 1.5 Female ISO	-WS-RMG20-MG14	-LWS-RMG20-MG14	-UWS-RMG20-MG14
Rotating M20 x 1.5 Female ISO	Ø 14 x 2.5	-WS-RMG20-MTB14	-LWS-RMG20-MTB14	-UWS-RMG20-MTB14
1/2 Female ISO Parallel Thread	M20 x 1.5 Female ISO	-WS-RG8-MG20	-LWS-RG8-MG20	-UWS-RG8-MG20
1/2 Female ISO Parallel Thread	M14 x 1.5 Female ISO	-WS-RG8-MG14	-LWS-RG8-MG14	-UWS-RG8-MG14
1/2 Female ISO Parallel Thread	Ø 14 x 2.5	-WS-RG8-MTB14	-LWS-RG8-MTB14	-UWS-RG8-MTB14
Rotating 1/2 Female ISO Parallel Thread	M20 x 1.5 Female ISO	-WS-RRG8-MG20	-LWS-RRG8-MG20	-UWS-RRG8-MG20
Rotating 1/2 Female ISO Parallel Thread	M14 x 1.5 Female ISO	-WS-RRG8-MG14	-LWS-RRG8-MG14	-UWS-RRG8-MG14
Rotating 1/2 Female ISO Parallel Thread	Ø 14 x 2.5	-WS-RRG8-MTB14	-LWS-RRG8-MTB14	-UWS-RRG8-MTB14
Ø 14 x 2.5	Ø 14 x 2.5	-WS-MTB14-T	-LWS-MTB14-T	-UWS-MTB14-T
1/2 Male NPT	1/2 Male NPT	-WS-NS8	-LWS-NS8	-UWS-NS8
1/2 Male NPT	1/4 Female NPT	-WS-NS8-FNS4	-LWS-NS8-FNS4	-UWS-NS8-FNS4
1/2 Male ISO Parallel Thread	1/4 Male ISO Parallel Thread	-WS-BP8-BP4	-LWS-BP8-BP4	-UWS-BP8-BP4
1/2 Male ISO Parallel Thread	1/4 Female ISO Parallel Thread	-WS-BP8-RG4	-LWS-BP8-RG4	-UWS-BP8-RG4
M20 x 1.5 Male ISO	M20 x 1.5 Female ISO	-WS-MS20-MG20	-LWS-MS20-MG20	-UWS-MS20-MG20
M20 x 1.5 Male ISO	M14 x 1.5 Female ISO	-WS-MS20-MG14	-LWS-MS20-MG14	-UWS-MS20-MG14
M14 x 1.5 Male ISO	M20 x 1.5 Female ISO	-WS-MS14-MG20	-LWS-MS14-MG20	-UWS-MS14-MG20
M14 x 1.5 Male ISO	M14 x 1.5 Female ISO	-WS-MS14-MG14	-LWS-MS14-MG14	-UWS-MS14-MG14

info@fitok.com
www.fitok.com

FK-IC-GO-02-EN-231226