

Face Seal Fittings

Fittings

Valves

Regulators

Filters

Tubing

Integrated Systems

Other Products

Technical Information



Contents

Metal Gasket Face Seal Fittings

FR Series

	Glands - G	F-21
---	------------	------

	Bodies - CM, CMB, CF, U, UB, BU, BW, RU, RA, RB, LM, LU, TTT, C	F-25
---	---	------

	Welded Glands - WG	F-30
---	--------------------	------

	Female Elbows - LWG	F-31
---	---------------------	------

	Female Tees - TWG	F-31
---	-------------------	------

	Nuts - N, MN, BC	F-31
---	------------------	------

	Plugs - PG	F-32
---	------------	------

	Caps - CP	F-33
---	-----------	------

	Flow Restrictors - R	F-33
---	----------------------	------

	Locking Device	F-33
---	----------------	------

	Gaskets - GT	F-34
---	--------------	------

	High-Flow Connections - "H" Type FR Fittings	F-36
---	---	------

L-Ring Face Seal Fittings

TFO Series

	Glands - G	F-40
---	------------	------

	Nuts - N	F-40
---	----------	------

	Tube Butt Weld Bodies - CW	F-41
---	----------------------------	------

	L-Ring Seal - GT	F-41
--	------------------	------

O-Ring Face Seal Fittings

FO Series

	Glands - G	F-45
---	------------	------

	Welded Glands - WG	F-46
---	--------------------	------

	Nuts - N	F-47
---	----------	------

	Bodies - CM, CF, U, UB, BY, BU, CW, LM, LU, LP, LU, TTT	F-47
---	---	------

	O-Rings	F-51
---	---------	------

	Gaskets	F-52
---	---------	------

Fittings

Valves

Regulators

Filters

Tubing

Integrated Systems

Other Products

Technical Information

Metal Gasket Face Seal Fittings

FR Series

Fittings

Valves

Regulators

Filters

Tubing

Integrated Systems

Other Products

Technical Information

Features

- ⦿ Metal-to-metal seal to provide perfect leak-tight service for working conditions from critical vacuum to high pressure
- ⦿ Precision manufactured gasket to ensure best performance
- ⦿ Test port at nut for easy leak testing
- ⦿ Silver-plated female threads
- ⦿ Standard surface roughness finished to an average of Ra 10 µin. (0.25 µm) or electropolished to Ra 5 µin. (0.13 µm) optional
- ⦿ All seal faces and male threads protected with plastic caps
- ⦿ Sizes range from 1/16" to 1" and 6 mm to 18 mm
- ⦿ Every gland and body marked with size, material and heat number



Technical Data

⦿ Thread Specifications

Thread Type	Specification
NPT	ASME B1.20.1, SAE AS71051
Unified (SAE)	ASME B1.1, SAE J475

⦿ Working Pressure

Working pressures shown in the Catalog are calculated according to ASME B31.3 and B31.1 at ambient temperature.

⦿ Materials

Material	Designator
Fitting Material	
316 SS	SS
316L SS	6L
316L SS VAR	6LV
316L SS VAR Ultra-low Mn	6LM
Gasket Material	
316L SS	6L
Copper	CU
Nickel	NI

⦿ Weld End Tube O.D. and Wall Thickness

Fractional		Metric	
Tube O.D. in.	Wall Thickness in.	Tube O.D. mm	Wall Thickness mm
1/8	0.028	6	1.0
1/4	0.035	8	1.0
3/8	0.035	10	1.0
1/2	0.049	12	1.0
3/4	0.049	18	1.5
1	0.065		
1 1/2	0.065		
2	0.065		

For other sizes or wall thicknesses of welded ports, please contact FITOK Group or our authorized distributors.

⦿ Working Temperature

Component	Material	Max. Temperature
Fittings	316 SS	1000 °F (538 °C)
	316L SS	
	316L SS VAR	
	316L SS VAR Ultra-low Mn	
Gaskets	316L SS	400 °F (204 °C)
	Copper	
	Nickel	

Process Specification

Item	Process Specification	
	Standard Cleaning and Packaging Process (FC-01) Special Cleaning and Packaging Process (FC-02)	Ultra High Purity Process (FC-03)
Material	316 SS, 316L SS	316L SS, 316L SS VAR, 316L SS VAR Ultra-low Mn
Wetted Surface Roughness	Ra 10 $\mu\text{in.}$ (0.25 μm)	Ra 5 $\mu\text{in.}$ (0.13 μm)
Polishing Process	Machine finished	Electropolished

Testing

FR fittings are rated to a maximum helium leak rate of 4×10^{-11} std cm^3/s .

Ordering Information

- ⦿ Each component can be ordered separately.
 - ⦿ Add the material designator as a prefix, cleaning and packaging designator as a suffix to the basic ordering number to get the complete ordering number.
 - ⦿ Cleaning and Packaging
 - a. Standard Cleaning and Packaging Process (FC-01) for general industrial procedures. No suffix is needed.
 - b. Special Cleaning and Packaging Process (FC-02), to ensure compliance with product cleanliness requirement as stated in ASTM G93 Level C. Add "-F2" as a suffix when needed.
 - c. Ultra High Purity Process (FC-03) is applied to products with wetted surface roughness finished to an average of Ra 5 $\mu\text{in.}$ (0.13 μm). Add "-F3" as a suffix when needed.
- Example: For 1/2" 316L SS VAR gland with Ultra High Purity Process (FC-03), the complete ordering number is 6LV-G-FR8-TB8-6-F3.

Installation Instructions

1. Assemble the gland, nut, gasket and male nut as below. Finger tight the nut.

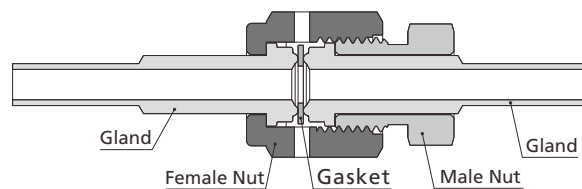

2. For fittings with 316L SS and nickel gaskets, tighten the nut 1/8 turn with a wrench while holding the male nut or the fitting body steady. Tighten the nut 1/4 turn for those with copper gaskets.

Cautions

- ⦿ Dimensions are for reference only and are subject to change
- ⦿ Over-tightening will damage the sealing beads and lead to possible leak
- ⦿ Utilize a new gasket for each assembly
- ⦿ Tungsten Inert Gas Welding (TIG) is recommended
- ⦿ Always apply sealing materials compatible with the fluid on tapered pipe threads
- ⦿ Do not loosen or tighten fittings when the system is pressurized
- ⦿ Integral FR fittings must remain stationary during installation. Integral male FR fittings should not be paired with integral female FR fittings. Instead, they should be used in conjunction with rotating nuts and glands.

Glands

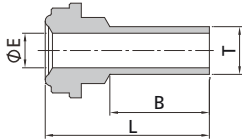

FR Gland to Short Fractional Tube Butt Weld

FR Size (in.)	T-Tube O.D. (in.)	Nominal Wall Thickness (in.)	Basic Ordering Number	Dimensions, in. (mm)			Working Pressure, psig (bar)		
				L	B	E	6L	CU	NI
1/8	1/8	0.028	-G-FR2-TB2-12S	1.08 (27.4)	0.75 (19.1)	0.07 (1.8)	8500 (586)	6800 (468)	8500 (586)
1/4	1/8	0.028	-G-FR4-TB2-12S	1.10 (27.9)	0.75 (19.1)	0.07 (1.8)	8500 (586)	6400 (440)	8000 (551)
1/4	1/4	0.035	-G-FR4-TB4-4S	0.60 (15.2)	0.25 (6.4)	0.18 (4.6)	5100 (351)	5100 (351)	5100 (351)
1/4	1/4	0.035	-G-FR4-TB4-6S	0.72 (18.3)	0.38 (9.6)	0.18 (4.6)	5100 (351)	5100 (351)	5100 (351)
1/4	1/4	0.035	-G-FR4-TB4-12S	1.10 (27.9)	0.75 (19.1)	0.18 (4.6)	5100 (351)	5100 (351)	5100 (351)
1/2	1/4	0.035	-G-FR8-TB4-12S	1.12 (28.4)	0.75 (19.1)	0.18 (4.6)	4300 (296)	2800 (192)	3500 (241)
1/2	3/8	0.035	-G-FR8-TB6-4S	0.62 (15.7)	0.25 (6.4)	0.31 (7.9)	3300 (227)	2600 (179)	3300 (227)
1/2	3/8	0.035	-G-FR8-TB6-12S	1.12 (28.4)	0.75 (19.1)	0.31 (7.9)	3300 (227)	2600 (179)	3300 (227)
1/2	1/2	0.049	-G-FR8-TB8-4S	0.62 (15.7)	0.25 (6.4)	0.40 (10.2)	3500 (241)	2800 (192)	3500 (241)
1/2	1/2	0.049	-G-FR8-TB8-6S	0.74 (18.8)	0.38 (9.6)	0.40 (10.2)	3500 (241)	2800 (192)	3500 (241)
1/2	1/2	0.049	-G-FR8-TB8-12S	1.12 (28.4)	0.75 (19.1)	0.40 (10.2)	3500 (241)	2800 (192)	3500 (241)

FR Gland to Short Metric Tube Butt Weld

FR Size (in.)	T-Tube O.D. (mm)	Nominal Wall Thickness (mm)	Basic Ordering Number	Dimensions, mm (in.)			Working Pressure, bar (psig)		
				L	B	E	6L	CU	NI
1/4	6	1.0	-G-FR4-MTB6-12S	29.5 (1.16)	19.1 (0.75)	4.0 (0.16)	468 (6800)	372 (5400)	468 (6800)
1/4	8	1.0	-G-FR4-MTB8-12S	29.5 (1.16)	19.1 (0.75)	6.0 (0.24)	337 (4900)	337 (4900)	337 (4900)
1/2	10	1.0	-G-FR8-MTB10-12S	29.5 (1.16)	19.1 (0.75)	8.0 (0.31)	241 (3500)	192 (2800)	241 (3500)
1/2	12	1.0	-G-FR8-MTB12-12S	29.5 (1.16)	19.1 (0.75)	10.0 (0.39)	213 (3100)	165 (2400)	213 (3100)
3/4	18	1.5	-G-FR12-MTB18-12S	31.0 (1.22)	19.1 (0.75)	15.0 (0.59)	206 (3000)	165 (2400)	206 (3000)

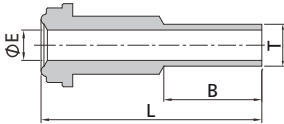

FR Gland to Long Fractional Tube Butt Weld

FR Size (in.)	T-Tube O.D. (in.)	Nominal Wall Thickness (in.)	Basic Ordering Number	Dimensions, in. (mm)			Working Pressure, psig (bar)		
				L	B	E	6L	CU	NI
1/8	1/8	0.028	-G-FR2-TB2-12	1.42 (36.1)	0.75 (19.1)	0.07 (1.8)	8500 (586)	6800 (468)	8500 (586)
1/4	1/4	0.035	-G-FR4-TB4-4	1.20 (30.5)	0.25 (6.4)	0.18 (4.6)	5100 (351)	5100 (351)	5100 (351)
1/4	1/4	0.035	-G-FR4-TB4-1.31	1.31 (33.3)	0.36 (9.1)	0.18 (4.6)	5100 (351)	5100 (351)	5100 (351)
1/4	1/4	0.035	-G-FR4-TB4-6	1.32 (33.5)	0.38 (9.6)	0.18 (4.6)	5100 (351)	5100 (351)	5100 (351)
1/4	1/4	0.035	-G-FR4-TB4-12	1.70 (43.2)	0.75 (19.1)	0.18 (4.6)	5100 (351)	5100 (351)	5100 (351)
1/2	1/4	0.035	-G-FR8-TB4-12	1.80 (45.7)	0.75 (19.1)	0.18 (4.6)	4300 (296)	2800 (192)	3500 (241)
1/2	3/8	0.035	-G-FR8-TB6-4	1.29 (32.8)	0.25 (6.4)	0.31 (7.9)	3300 (227)	2600 (179)	3300 (227)
1/2	3/8	0.035	-G-FR8-TB6-12	1.79 (45.5)	0.75 (19.1)	0.31 (7.9)	3300 (227)	2600 (179)	3300 (227)
1/2	1/2	0.049	-G-FR8-TB8-4	1.29 (32.8)	0.25 (6.4)	0.40 (10.2)	3500 (241)	2800 (192)	3500 (241)
1/2	1/2	0.049	-G-FR8-TB8-6	1.41 (35.8)	0.38 (9.6)	0.40 (10.2)	3500 (241)	2800 (192)	3500 (241)
1/2	1/2	0.049	-G-FR8-TB8-12	1.79 (45.5)	0.75 (19.1)	0.40 (10.2)	3500 (241)	2800 (192)	3500 (241)
3/4	3/4	0.049	-G-FR12-TB12-12	2.03 (51.6)	0.75 (19.1)	0.65 (16.5)	2400 (165)	1900 (130)	2400 (165)
1	1	0.065	-G-FR16-TB16-12	2.32 (58.9)	0.75 (19.1)	0.87 (22.1)	2400 (165)	1900 (130)	2400 (165)

① The suffix "-1.31" refers to the length of Dimension L, L=1.31" (33.3 mm).

FR Gland to Long Metric Tube Butt Weld

FR Size (in.)	T-Tube O.D. (mm)	Nominal Wall Thickness (mm)	Basic Ordering Number	Dimensions, mm (in.)			Working Pressure, bar (psig)		
				L	B	E	6L	CU	NI
1/4	6	1.0	-G-FR4-MTB6-12	43.2 (1.7)	19.1 (0.75)	4.0 (0.16)	468 (6800)	372 (5400)	468 (6800)
1/4	8	1.0	-G-FR4-MTB8-12	43.2 (1.7)	19.1 (0.75)	6.0 (0.24)	337 (4900)	337 (4900)	337 (4900)
1/2	10	1.0	-G-FR8-MTB10-12	45.5 (1.79)	19.1 (0.75)	8.0 (0.31)	241 (3500)	192 (2800)	241 (3500)
1/2	12	1.0	-G-FR8-MTB12-12	45.5 (1.79)	19.1 (0.75)	10.0 (0.39)	213 (3100)	165 (2400)	213 (3100)
3/4	18	1.5	-G-FR12-MTB18-12	51.6 (2.03)	19.1 (0.75)	15.0 (0.59)	206 (3000)	165 (2400)	206 (3000)

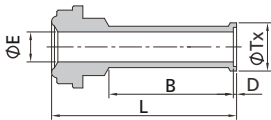

FR Gland to Short Fractional Automatic Tube Butt Weld

FR Size (in.)	Tube O.D. (in.)	Nominal Wall Thickness (in.)	Basic Ordering Number	Dimensions, in. (mm)					Working Pressure, psig (bar)		
				L	B	D	E	Tx	6L	CU	NI
1/4	1/4	0.035	-AG-FR4-TB4-12S	1.12 (28.4)	0.75 (19.1)	0.02 (0.5)	0.18 (4.6)	0.29 (7.4)	5100 (351)	5100 (351)	5100 (351)
1/2	3/8	0.035	-AG-FR8-TB6-12S	1.15 (29.2)	0.75 (19.1)	0.03 (0.8)	0.31 (7.9)	0.41 (10.4)	3300 (227)	2600 (179)	3300 (227)
1/2	1/2	0.049	-AG-FR8-TB8-12S	1.16 (29.5)	0.75 (19.1)	0.04 (1.0)	0.40 (10.2)	0.55 (14.0)	3500 (241)	2800 (192)	3500 (241)

FR Gland to Short Metric Automatic Tube Butt Weld

FR Size (in.)	Tube O.D. (mm)	Nominal Wall Thickness (mm)	Basic Ordering Number	Dimensions, mm (in.)					Working Pressure, bar (psig)		
				L	B	D	E	Tx	6L	CU	NI
1/4	6	1.0	-AG-FR4-MTB6-12S	30.0 (1.18)	19.1 (0.75)	0.5 (0.02)	4.0 (0.16)	6.8 (0.27)	468 (6800)	372 (5400)	468 (6800)
1/4	8	1.0	-AG-FR4-MTB8-12S	30.2 (1.19)	19.1 (0.75)	0.8 (0.03)	6.0 (0.24)	8.9 (0.35)	337 (4900)	337 (4900)	337 (4900)
1/2	10	1.0	-AG-FR8-MTB10-12S	31.0 (1.22)	19.1 (0.75)	0.8 (0.03)	8.0 (0.31)	10.9 (0.43)	241 (3500)	192 (2800)	241 (3500)
1/2	12	1.0	-AG-FR8-MTB12-12S	30.5 (1.20)	19.1 (0.75)	1.0 (0.04)	10.0 (0.39)	13.2 (0.52)	213 (3100)	165 (2400)	213 (3100)

F-23 Face Seal Fittings

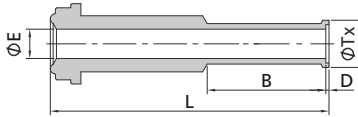

FR Gland to Long Fractional Automatic Tube Butt Weld

FR Size (in.)	Tube O.D. (in.)	Nominal Wall Thickness (in.)	Basic Ordering Number	Dimensions, in. (mm)					Working Pressure, psig (bar)		
				L	B	D	E	Tx	6L	CU	NI
1/4	1/4	0.035	-AG-FR4-TB4-12	1.72 (43.7)	0.75 (19.1)	0.02 (0.5)	0.18 (4.6)	0.29 (7.4)	5100 (351)	5100 (351)	5100 (351)
1/2	1/4	0.035	-AG-FR8-TB4-12	1.82 (46.2)	0.75 (19.1)	0.02 (0.5)	0.18 (4.6)	0.29 (7.4)	3500 (241)	2800 (192)	3500 (241)
1/2	3/8	0.035	-AG-FR8-TB6-12	1.82 (46.2)	0.75 (19.1)	0.03 (0.8)	0.31 (7.9)	0.41 (10.4)	3300 (227)	2600 (179)	3300 (227)
1/2	1/2	0.049	-AG-FR8-TB8-12	1.83 (46.5)	0.75 (19.1)	0.04 (1.0)	0.40 (10.2)	0.55 (14.0)	3500 (241)	2800 (192)	3500 (241)
3/4	3/4	0.049	-AG-FR12-TB12-12	2.07 (52.6)	0.75 (19.1)	0.04 (1.0)	0.65 (16.5)	0.80 (20.3)	2400 (165)	2400 (165)	2400 (165)
1	1	0.065	-AG-FR16-TB16-16	2.57 (65.3)	0.96 (24.4)	0.04 (1.0)	0.87 (22.1)	1.06 (26.9)	2400 (165)	1900 (130)	2400 (165)

FR Gland to Long Metric Automatic Tube Butt Weld

FR Size (in.)	Tube O.D. (mm)	Nominal Wall Thickness (mm)	Basic Ordering Number	Dimensions, mm (in.)					Working Pressure, bar (psig)		
				L	B	D	E	Tx	6L	CU	NI
1/4	6	1.0	-AG-FR4-MTB6-12	43.7 (1.72)	19.1 (0.75)	0.5 (0.02)	4.0 (0.16)	6.8 (0.27)	468 (6800)	372 (5400)	468 (6800)
1/2	12	1.0	-AG-FR8-MTB12-12	46.5 (1.83)	19.1 (0.75)	1.0 (0.04)	10.0 (0.39)	13.2 (0.52)	213 (3100)	165 (2400)	213 (3100)
3/4	18	1.5	-AG-FR12-MTB18-12	52.6 (2.07)	19.1 (0.75)	1.0 (0.04)	15.0 (0.59)	19.3 (0.76)	206 (3000)	165 (2400)	206 (3000)

1. The suffixes "-4", "-6", and "-12" indicate the length of Dimension B. Example: The suffix "-12" means B=12x1/16"=3/4" (19.1 mm).
2. The "S" in the suffix "-4S" indicates that the gland is a short tube.

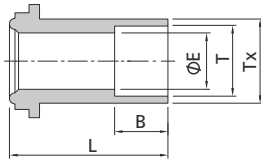

FR Gland to Short Tube Socket Weld

FR Size (in.)	T-Tube O.D. (in.)	Basic Ordering Number	Dimensions, in. (mm)				Working Pressure, psig (bar)		
			L	B	E	Tx	6L	CU	NI
1/4	1/4	-G-FR4-TS4-0.50	0.50 (12.7)	0.28 (7.1)	0.18 (4.6)	0.35 (8.9)	5500 (378)	5500 (378)	5500 (378)
1/4	1/4	-G-FR4-TS4-0.75	0.75 (19.1)	0.28 (7.1)	0.18 (4.6)	0.35 (8.9)	5500 (378)	5500 (378)	5500 (378)

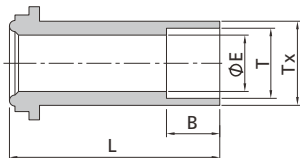

FR Gland to Tube Socket Weld

FR Size (in.)	T-Tube O.D. (in.)	Basic Ordering Number	Dimensions, in. (mm)				Working Pressure, psig (bar)		
			L	B	E	Tx	6L	CU	NI
1/8	1/16	-G-FR2-TS1	0.70 (17.8)	0.10 (2.5)	0.05 (1.3)	0.13 (3.3)	9000 (620)	7200 (496)	9000 (620)
1/8	1/8	-G-FR2-TS2	0.70 (17.8)	0.10 (2.5)	0.09 (2.3)	0.20 (5.1)	7100 (489)	7100 (489)	7100 (489)
1/4	1/4	-G-FR4-TS4	1.31 (33.3)	0.28 (7.1)	0.18 (4.6)	0.35 (8.9)	5500 (378)	5500 (378)	5500 (378)
1/2	3/8	-G-FR8-TS6	1.50 (38.1)	0.31 (7.9)	0.28 (7.1)	0.60 (15.2)	4300 (296)	2800 (192)	3500 (241)
1/2	1/2	-G-FR8-TS8	1.50 (38.1)	0.38 (9.7)	0.40 (10.2)	0.60 (15.2)	3000 (206)	2400 (165)	3000 (206)
5/8	5/8	-G-FR10-TS10	1.56 (39.6)	0.41 (10.4)	0.50 (12.7)	0.72 (18.3)	2800 (192)	2200 (151)	2800 (192)
3/4	3/4	-G-FR12-TS12	2.00 (50.8)	0.44 (11.2)	0.62 (15.7)	0.88 (22.4)	2800 (192)	2200 (151)	2800 (192)
1	1	-G-FR16-TS16	2.22 (56.4)	0.62 (15.7)	0.87 (22.1)	1.19 (30.2)	3000 (206)	1900 (130)	2400 (165)

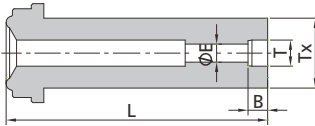

Reducing Socket Weld

FR Size (in.)	T-Tube O.D. (in.)	Basic Ordering Number	Dimensions, in. (mm)				Working Pressure, psig (bar)		
			L	B	E	Tx	6L	CU	NI
1/4	1/8	-G-FR4-RTS2	1.31 (33.3)	0.10 (2.5)	0.09 (2.3)	0.35 (8.9)	8000 (551)	8000 (551)	8000 (551)
1/2	1/4	-G-FR8-RTS4	1.50 (38.1)	0.28 (7.1)	0.18 (4.6)	0.60 (15.2)	3500 (241)	3500 (241)	3500 (241)

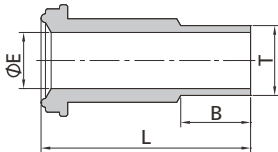

FR Gland to Fractional Tube Butt Weld

FR Size (in.)	T-Tube O.D. (in.)	T-Tube Wall Thickness (in.)	Basic Ordering Number	Dimensions, in. (mm)			Working Pressure, psig (bar)		
				L	B	E	6L	CU	NI
1/8	1/8	0.032	-G-FR2-TB2×032	0.70 (17.8)	0.28 (7.1)	0.06 (1.5)	11200 (772)	7200 (496)	9000 (620)
1/4	1/8	0.032	-G-FR4-TB2×032	1.31 (33.3)	0.28 (7.1)	0.06 (1.5)	10000 (690)	6400 (440)	8000 (551)
1/4	1/4	0.065	-G-FR4-TB4×065	1.31 (33.3)	0.41 (10.4)	0.12 (3.0)	10000 (690)	6400 (440)	8000 (551)
1/2	1/4	0.065	-G-FR8-TB4×065	1.50 (38.1)	0.41 (10.4)	0.12 (3.0)	4300 (296)	2800 (192)	3500 (241)
1/2	3/8	0.049	-G-FR8-TB6×049	1.50 (38.1)	0.41 (10.4)	0.28 (7.1)	4300 (296)	2800 (192)	3500 (241)
1/2	1/2	0.049	-G-FR8-TB8	1.50 (38.1)	0.50 (12.7)	0.40 (10.2)	3500 (241)	3500 (241)	3500 (241)
3/4	3/4	0.109	-G-FR12-TB12×109	2.00 (50.8)	0.62 (15.7)	0.53 (13.5)	3700 (254)	2400 (165)	3000 (206)
1	1	0.125	-G-FR16-TB16×125	2.22 (56.4)	0.81 (20.6)	0.75 (19.1)	3000 (206)	1900 (130)	2400 (165)

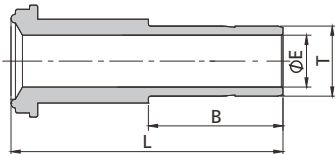

FR Gland to Tube Port

FR Size (in.)	T-Tube O.D. (in.)	Basic Ordering Number	Dimensions, in. (mm)			Working Pressure, psig (bar)		
			L	B	E	6L	CU	NI
1/4	1/4	-G-FR4-FT4	1.62 (41.0)	0.64 (16.2)	0.17 (4.3)	10000 (690)	6400 (440)	8000 (551)
1/2	3/8	-G-FR8-FT6	1.81 (46.0)	0.70 (17.8)	0.27 (6.9)	4300 (296)	2800 (192)	3500 (241)
1/2	1/2	-G-FR8-FT8	1.94 (49.3)	0.96 (24.4)	0.37 (9.4)	4300 (296)	2800 (192)	3500 (241)

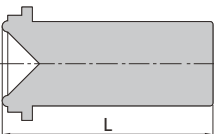

Blind Gland

FR Size (in.)	Basic Ordering Number	Dimension, in. (mm)
		L
1/8	-G-FR2-B	0.70 (17.8)
1/4	-G-FR4-B	1.31 (33.3)
1/2	-G-FR8-B	1.50 (38.1)
3/4	-G-FR12-B	2.00 (50.8)
1	-G-FR16-B	2.22 (56.4)

Fittings

Valves

Regulators

Filters

Tubing

Integrated Systems

Other Products

Technical Information

Bodies

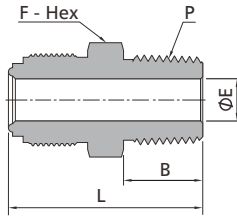

FR Body to Male NPT

FR Size (in.)	P-NPT Size	Basic Ordering Number	Dimensions, in. (mm)				Working Pressure, psig (bar)		
			L	B	E	F	6L	CU	NI
1/8	1/16	-CM-FR2-NS1	1.07 (27.2)	0.38 (9.7)	0.09 (2.3)	3/8 (9.5)	9000 (620)	7200 (496)	9000 (620)
1/8	1/8	-CM-FR2-NS2	1.07 (27.2)	0.38 (9.7)	0.09 (2.3)	7/16 (11.1)	9000 (620)	7200 (496)	9000 (620)
1/4	1/8	-CM-FR4-NS2	1.31 (33.3)	0.38 (9.7)	0.18 (4.6)	5/8 (15.9)	10000 (690)	6400 (440)	8000 (551)
1/4	1/4	-CM-FR4-NS4	1.49 (37.8)	0.56 (14.2)	0.18 (4.6)	5/8 (15.9)	10000 (690)	6400 (440)	8000 (551)
1/2	1/4	-CM-FR8-NS4	1.65 (41.9)	0.56 (14.2)	0.28 (7.1)	15/16 (23.8)	4300 (296)	2800 (192)	3500 (241)
1/2	3/8	-CM-FR8-NS6	1.65 (41.9)	0.56 (14.2)	0.38 (9.7)	15/16 (23.8)	4300 (296)	2800 (192)	3500 (241)
1/2	1/2	-CM-FR8-NS8	1.84 (46.7)	0.75 (19.1)	0.40 (10.2)	15/16 (23.8)	4300 (296)	2800 (192)	3500 (241)
3/4	3/4	-CM-FR12-NS12	2.19 (55.6)	0.75 (19.1)	0.62 (15.7)	1 15/16 (33.3)	3700 (254)	2400 (165)	3000 (206)
1	1	-CM-FR16-NS16	2.47 (62.7)	0.94 (23.9)	0.87 (22.1)	1 5/8 (41.3)	3000 (206)	1900 (130)	3000 (206)

Note: Integral FR fittings must remain stationary during installation and should be used in conjunction with rotating nuts and glands.

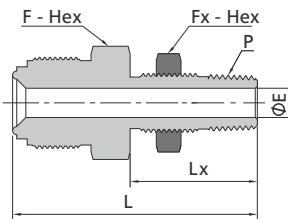

FR Body to Bulkhead Male Connector

FR Size (in.)	P-NPT Size	Basic Ordering Number	Dimensions, in. (mm)					Panel Hole Size in. (mm)	Max. Panel Thickness in. (mm)	Working Pressure, psig (bar)		
			L	Lx	E	F	Fx			6L	CU	NI
1/4	1/4	-CMB-FR4-NS4	2.21 (56.1)	1.24 (31.5)	0.28 (7.1)	13/16 (20.6)	13/16 (20.6)	21/32 (16.7)	0.38 (9.7)	8000 (551)	6400 (440)	8000 (551)
1/2	1/4	-CMB-FR8-NS4	2.34 (59.4)	1.24 (31.5)	0.28 (7.1)	15/16 (23.8)	13/16 (20.6)	21/32 (16.7)	0.38 (9.7)	4370 (301)	2800 (192)	3500 (241)

Note: Integral FR fittings must remain stationary during installation and should be used in conjunction with rotating nuts and glands.

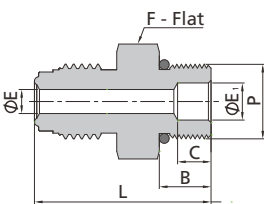

FR Body to SAE/MS Thread

FR Size (in.)	P-SAE/MS Thread Size	Uniform O-Ring ^① Size	Basic Ordering Number	Dimensions, in. (mm)						Working Pressure, psig (bar)		
				L	B	C	E	E ₁	F	6L	CU	NI
1/4	9/16-18	906	-CM-FR4-ST9	1.33 (33.8)	0.39 (9.9)	0.25 (6.4)	0.18 (4.6)	0.28 (7.1)	3/4 (19.1)	4500 (310)	4500 (310)	4500 (310)
1/2	9/16-18	906	-CM-FR8-ST9	1.48 (37.6)	0.39 (9.9)	-	0.28 (7.1)	0.28 (7.1)	15/16 (23.8)	3500 (241)	2800 (192)	3500 (241)
1/2	7/8-14	910	-CM-FR8-ST14	1.66 (42.2)	0.50 (12.7)	0.40 (10.2)	0.28 (7.1)	0.59 (15.0)	1 (25.4)	3500 (241)	2800 (192)	3500 (241)

Notes: ① The bodies are supplied with O-rings. Fluorocarbon FKM is standard O-ring material, contact FITOK Group for other materials. Fluorocarbon FKM O-rings are internally lubricated, no external lubricants are required.

Integral FR fittings must remain stationary during installation and should be used in conjunction with rotating nuts and glands.

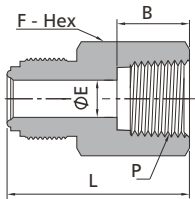

FR Body to Female NPT

FR Size (in.)	P-NPT Size	Basic Ordering Number	Dimensions, in. (mm)				Working Pressure, psig (bar)		
			L	B	E	F	6L	CU	NI
1/8	1/16	-CF-FR2-NS1	1.10 (27.9)	0.39 (9.9)	0.09 (2.3)	7/16 (11.1)	6700 (461)	6700 (461)	6700 (461)
1/8	1/8	-CF-FR2-NS2	1.19 (30.2)	0.41 (10.4)	0.09 (2.3)	9/16 (14.3)	6500 (447)	6500 (447)	6500 (447)
1/4	1/8	-CF-FR4-NS2	1.41 (35.8)	0.41 (10.4)	0.18 (4.6)	5/8 (15.9)	8000 (551)	6400 (440)	8000 (551)
1/4	1/4	-CF-FR4-NS4	1.54 (39.1)	0.59 (15.0)	0.18 (4.6)	3/4 (19.1)	6600 (454)	5200 (358)	6600 (454)
1/2	3/8	-CF-FR8-NS6	1.76 (44.7)	0.59 (15.0)	0.40 (10.2)	15/16 (23.8)	4300 (296)	2800 (192)	3500 (241)
1/2	1/2	-CF-FR8-NS8	1.99 (50.5)	0.78 (19.8)	0.40 (10.2)	1 1/16 (27.0)	4300 (296)	2800 (192)	3500 (241)
3/4	3/4	-CF-FR12-NS12	2.36 (59.9)	0.81 (20.6)	0.62 (15.7)	1 5/16 (33.3)	3700 (254)	2400 (165)	3000 (206)
1	1	-CF-FR16-NS16	2.51 (63.8)	1.00 (25.4)	0.87 (22.1)	1 5/8 (41.3)	3000 (206)	1900 (130)	2400 (165)

Note: Integral FR fittings must remain stationary during installation and should be used in conjunction with rotating nuts and glands.

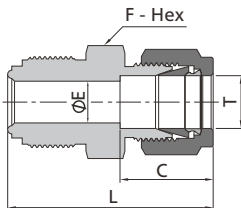

FR Body to Tube Fitting

FR Size (in.)	T-Tube O.D. (in.)	Basic Ordering Number	Dimensions, in. (mm)				Working Pressure, psig (bar)		
			L ^①	C	E	F	6L	CU	NI
1/4	1/8	-U-FR4-FL2	1.53 (38.9)	0.50 (12.7)	0.09 (2.3)	5/8 (15.9)	10000 (690)	6400 (440)	8000 (551)
1/4	1/4	-U-FR4-FL4	1.62 (41.1)	0.60 (15.2)	0.18 (4.6)	5/8 (15.9)	10000 (690)	6400 (440)	8000 (551)
1/2	3/8	-U-FR8-FL6	1.84 (46.7)	0.66 (16.8)	0.28 (7.1)	15/16 (23.8)	4300 (296)	2800 (192)	3500 (241)
1/2	1/2	-U-FR8-FL8	1.95 (49.5)	0.90 (22.9)	0.40 (10.2)	15/16 (23.8)	4300 (296)	2800 (192)	3500 (241)

Notes: ① Dimension L is with FITOK nuts finger-tight.
Integral FR fittings must remain stationary during installation and should be used in conjunction with rotating nuts and glands.

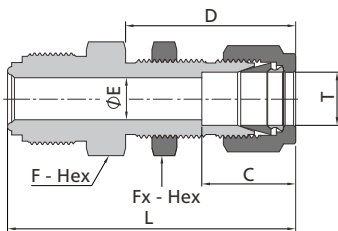

FR Body to Bulkhead Tube Fitting Union

FR Size (in.)	T-Tube O.D. (in.)	Basic Ordering Number	Dimensions, in. (mm)						Panel Hole Size in. (mm)	Max. Panel Thickness in. (mm)	Working Pressure, psig (bar)		
			L ^①	C	D	E	F	Fx			6L	CU	NI
1/4	1/4	-UB-FR4-FL4	2.25 (57.2)	0.60 (15.2)	1.32 (33.5)	0.18 (4.6)	5/8 (15.9)	5/8 (15.9)	15/32 (11.9)	0.40 (10.2)	10000 (690)	6400 (440)	8000 (551)
1/4	1/4	-UB-FR4-FL4-1.88	1.88 (47.8)	0.60 (15.2)	1.05 (26.7)	0.18 (4.6)	5/8 (15.9)	5/8 (15.9)	15/32 (11.9)	0.13 (3.3)	10000 (690)	6400 (440)	8000 (551)
1/2	3/8	-UB-FR8-FL6	2.54 (64.5)	0.66 (16.8)	1.45 (36.8)	0.28 (7.1)	15/16 (23.8)	3/4 (19.1)	19/32 (15.0)	0.44 (11.2)	4300 (296)	2800 (192)	3500 (241)
1/2	1/2	-UB-FR8-FL8	2.74 (69.6)	0.90 (22.9)	1.65 (41.9)	0.40 (10.2)	15/16 (23.8)	15/16 (23.8)	25/32 (19.8)	0.50 (12.7)	4300 (296)	2800 (192)	3500 (241)

Notes: ① Dimension L is with FITOK nuts finger-tight.
Integral FR fittings must remain stationary during installation and should be used in conjunction with rotating nuts and glands.

F-27 Face Seal Fittings

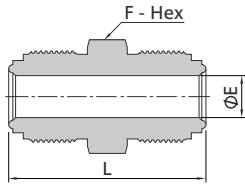

Union Body

FR Size (in.)	FR Size (in.)	Basic Ordering Number	Dimensions, in. (mm)			Working Pressure, psig (bar)		
			L	E	F	6L	CU	NI
1/8	1/8	-U-FR2	1.13 (28.7)	0.09 (2.3)	3/8 (9.5)	11200 (772)	7200 (496)	9000 (620)
1/4	1/4	-U-FR4	1.55 (39.4)	0.18 (4.6)	5/8 (15.9)	10000 (690)	6400 (440)	8000 (551)
1/2	1/2	-U-FR8	1.84 (46.7)	0.40 (10.2)	15/16 (23.8)	4300 (296)	2800 (192)	3500 (241)
3/4	3/4	-U-FR12	2.44 (62.0)	0.62 (15.7)	1 5/16 (33.3)	3700 (254)	2400 (165)	3000 (206)
1	1	-U-FR16	2.59 (65.8)	0.87 (22.1)	1 5/8 (41.3)	3000 (206)	1900 (130)	2400 (165)

Note: Integral FR fittings must remain stationary during installation and should be used in conjunction with rotating nuts and glands.

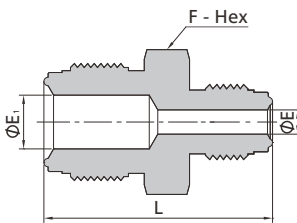

Reducing Union

FR Size (in.)	FR Size (in.)	Basic Ordering Number	Dimensions, in. (mm)				Working Pressure, psig (bar)		
			L	E	E ₁	F	6L	CU	NI
1/4	1/8	-U-FR4-FR2	1.37 (34.8)	0.09 (2.3)	0.18 (4.6)	5/8 (15.9)	10000 (690)	6400 (440)	8000 (551)
1/2	1/4	-U-FR8-FR4	1.71 (43.4)	0.18 (4.6)	0.40 (10.2)	5/16 (23.8)	4300 (296)	2800 (192)	3500 (241)

Note: Integral FR fittings must remain stationary during installation and should be used in conjunction with rotating nuts and glands.

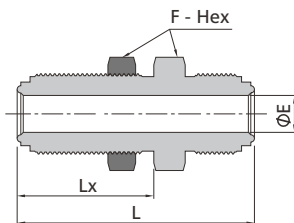

Bulkhead Union Body

FR Size (in.)	Basic Ordering Number	Dimensions, in. (mm)				Panel Hole Drill Size in. (mm)	Max. Panel Thickness in. (mm)	Working Pressure, psig (bar)		
		L	Lx	E	F			6L	CU	NI
1/4	-BU-FR4-1.82	1.82 (46.2)	0.99 (25.1)	0.18 (4.6)	3/4 (19.1)	19/32 (15.0)	0.13 (3.3)	10000 (690)	6400 (440)	8000 (551)
1/4	-BU-FR4	2.23 (56.6)	1.30 (33.3)	0.18 (4.6)	3/4 (19.1)	19/32 (15.0)	0.44 (11.2)	10000 (690)	6400 (440)	8000 (551)
1/2	-BU-FR8-2.14	2.14 (54.4)	1.11 (28.2)	0.40 (10.2)	1 1/16 (27.0)	29/32 (23.1)	0.13 (3.3)	4300 (296)	2800 (192)	3500 (241)
1/2	-BU-FR8	2.57 (65.3)	1.48 (37.6)	0.40 (10.2)	1 1/16 (27.0)	29/32 (23.1)	0.50 (12.7)	4300 (296)	2800 (192)	3500 (241)

Note: Integral FR fittings must remain stationary during installation and should be used in conjunction with rotating nuts and glands.

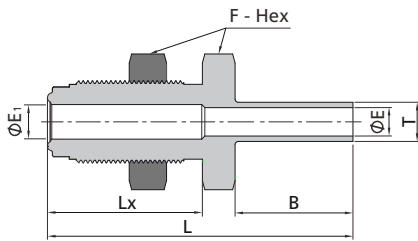

FR Bulkhead Body to Tube Butt Weld

FR Size (in.)	T-Tube O.D. (in.)	T-Tube Wall Thickness (in.)	Basic Ordering Number	Dimensions, in. (mm)						Panel Hole Drill Size in. (mm)	Max. Panel Thickness in. (mm)	Working Pressure, psig (bar)		
				L	Lx	B	E	E ₁	F			6L	CU	NI
1/4	1/4	0.035	-BW-FR4-TB4-1.95	1.95 (49.5)	0.99 (25.1)	0.75 (19.1)	0.18 (4.6)	0.22 (5.6)	0.75 (19.1)	19/32 (15.1)	0.13 (3.3)	5100 (351)	5100 (351)	5100 (351)
1/4	1/4	0.035	-BW-FR4-TB4	2.36 (59.9)	1.30 (33.0)	0.75 (19.1)	0.18 (4.6)	0.22 (5.6)	0.75 (19.1)	19/32 (15.1)	0.44 (11.2)	5100 (351)	5100 (351)	5100 (351)

Note: Integral FR fittings must remain stationary during installation and should be used in conjunction with rotating nuts and glands.

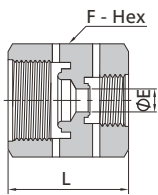

Female Reducing Union

FR Size (in.)	FR Size (in.)	Basic Ordering Number	Dimensions, in. (mm)			Working Pressure, psig (bar)		
			L	E	F	6L	CU	NI
1/4	1/8	-RU-FR4-FR2	1.16 (29.5)	0.13 (3.3)	3/4 (19.1)	10000 (690)	6400 (440)	8000 (551)
1/2	1/4	-RU-FR8-FR4	1.41 (35.8)	0.25 (6.4)	1 1/16 (27.0)	4300 (296)	2800 (192)	3500 (241)

Note: Integral FR fittings must remain stationary during installation and should be used in conjunction with rotating nuts and glands.

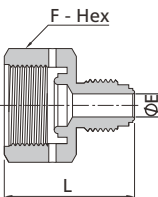

Reducing Adapter

FR Size (in.)	FR Size (in.)	Basic Ordering Number	Dimensions, in. (mm)			Working Pressure, psig (bar)		
			L	E	F	6L	CU	NI
1/4	1/8	-RA-FR4-FR2	1.19 (30.2)	0.09 (2.3)	3/4 (19.1)	10000 (690)	6400 (440)	8000 (551)
1/2	1/4	-RA-FR8-FR4	1.41 (35.8)	0.18 (4.6)	1 1/16 (27.0)	4300 (296)	2800 (192)	3500 (241)

Note: Integral FR fittings must remain stationary during installation and should be used in conjunction with rotating nuts and glands.

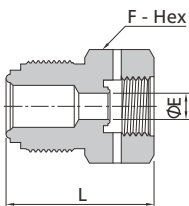

Reducing Bushing

FR Size (in.)	FR Size (in.)	Basic Ordering Number	Dimensions, in. (mm)			Working Pressure, psig (bar)		
			L	E	F	6L	CU	NI
1/4	1/8	-RB-FR4-FR2	1.06 (26.9)	0.13 (3.3)	5/8 (15.9)	10000 (690)	6400 (440)	8000 (551)
1/2	1/4	-RB-FR8-FR4	1.41 (35.8)	0.25 (6.4)	15/16 (23.8)	4300 (296)	2800 (192)	3500 (241)

Note: Integral FR fittings must remain stationary during installation and should be used in conjunction with rotating nuts and glands.

Fittings

Valves

Regulators

Filters

Tubing

Integrated Systems

Other Products

Technical Information

F-29 Face Seal Fittings

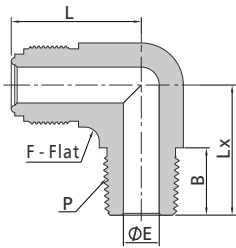

FR Body to Male NPT Elbow

FR Size (in.)	P-NPT Size	Basic Ordering Number	Dimensions, in. (mm)					Working Pressure, psig (bar)		
			L	Lx	B	E	F	6L	CU	NI
1/4	1/8	-LM-FR4-NS2	1.07 (27.2)	0.87 (22.1)	0.38 (9.6)	0.18 (4.6)	1/2 (12.7)	10000 (690)	6400 (440)	8000 (551)
1/4	1/4	-LM-FR4-NS4	1.07 (27.2)	1.05 (26.7)	0.56 (14.2)	0.18 (4.6)	1/2 (12.7)	8000 (551)	8000 (551)	8000 (551)
1/2	3/8	-LM-FR8-NS6	1.45 (36.8)	1.26 (32.0)	0.56 (14.2)	0.40 (10.2)	13/16 (20.6)	4300 (296)	2800 (192)	3500 (241)
1/2	1/2	-LM-FR8-NS8	1.45 (36.8)	1.45 (36.8)	0.75 (19.1)	0.40 (10.2)	13/16 (20.6)	4300 (296)	2800 (192)	3500 (241)

Note: Integral FR fittings must remain stationary during installation and should be used in conjunction with rotating nuts and glands.

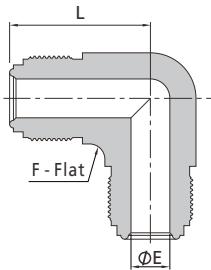

FR Body Union Elbow

FR Size (in.)	Basic Ordering Number	Dimensions, in. (mm)			Working Pressure, psig (bar)		
		L	E	F	6L	CU	NI
1/8	-LU-FR2	0.89 (22.6)	0.09 (2.3)	7/16 (11.1)	11200 (772)	7200 (496)	9000 (620)
1/4	-LU-FR4	1.07 (27.2)	0.18 (4.6)	1/2 (12.7)	10000 (690)	6400 (440)	8000 (551)
1/2	-LU-FR8	1.45 (36.8)	0.40 (10.2)	13/16 (20.6)	4300 (296)	2800 (192)	3500 (241)
3/4	-LU-FR12	1.92 (48.8)	0.62 (15.7)	1 1/4 (31.8)	3700 (254)	2400 (165)	3000 (206)
1	-LU-FR16	2.00 (50.8)	0.87 (22.1)	1 11/16 (42.9)	3000 (206)	1900 (130)	2400 (165)

Note: Integral FR fittings must remain stationary during installation and should be used in conjunction with rotating nuts and glands.

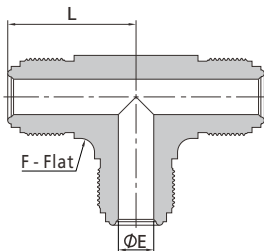

FR Body Union Tee

FR Size (in.)	Basic Ordering Number	Dimensions, in. (mm)			Working Pressure, psig (bar)		
		L	E	F	6L	CU	NI
1/8	-TTT-FR2	0.89 (22.6)	0.09 (2.3)	7/16 (11.1)	11200 (772)	7200 (496)	9000 (620)
1/4	-TTT-FR4	1.07 (27.2)	0.18 (4.6)	1/2 (12.7)	10000 (690)	6400 (440)	8000 (551)
1/2	-TTT-FR8	1.45 (36.8)	0.40 (10.2)	13/16 (20.6)	4300 (296)	2800 (192)	3500 (241)
3/4	-TTT-FR12	1.92 (48.8)	0.62 (15.7)	1 1/4 (31.8)	3700 (254)	2400 (165)	3000 (206)
1	-TTT-FR16	2.00 (50.8)	0.87 (22.1)	1 11/16 (42.9)	3000 (206)	1900 (130)	2400 (165)

Note: Integral FR fittings must remain stationary during installation and should be used in conjunction with rotating nuts and glands.

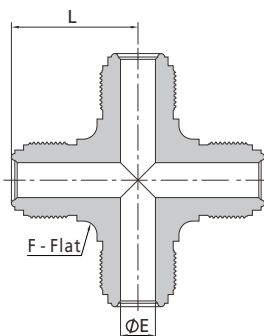

FR Body Union Cross

FR Size (in.)	Basic Ordering Number	Dimensions, in. (mm)			Working Pressure, psig (bar)		
		L	E	F	6L	CU	NI
1/8	-C-FR2	0.89 (22.6)	0.09 (2.3)	7/16 (11.1)	11200 (772)	7200 (496)	9000 (620)
1/4	-C-FR4	1.07 (27.2)	0.18 (4.6)	1/2 (12.7)	10000 (690)	6400 (440)	8000 (551)
1/2	-C-FR8	1.45 (36.8)	0.40 (10.2)	13/16 (20.6)	4300 (296)	2800 (192)	3500 (241)
3/4	-C-FR12	1.92 (48.8)	0.62 (15.7)	1 1/4 (31.8)	3700 (254)	2400 (165)	3000 (206)
1	-C-FR16	2.00 (50.8)	0.87 (22.1)	1 11/16 (42.9)	3000 (206)	1900 (130)	2400 (165)

Note: Integral FR fittings must remain stationary during installation and should be used in conjunction with rotating nuts and glands.

Welded Glands

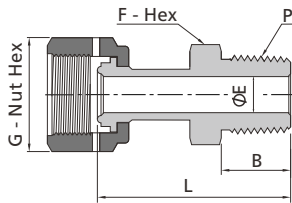

FR Welded Gland to Male NPT

FR Size (in.)	P-NPT Size	Basic Ordering Number	Dimensions, in. (mm)					Working Pressure, psig (bar)		
			L	B	E	G	F	6L	CU	NI
1/4	1/8	-WG-FR4-NS2	1.58 (40.1)	0.38 (9.7)	0.18 (4.6)	3/4 (19.1)	7/16 (11.1)	8000 (551)	6400 (446)	8000 (551)
1/4	1/4	-WG-FR4-NS4	1.79 (45.5)	0.56 (14.2)	0.18 (4.6)	3/4 (19.1)	9/16 (14.3)	8000 (551)	6400 (446)	8000 (551)
1/2	3/8	-WG-FR8-NS6	1.89 (48.0)	0.56 (14.2)	0.40 (10.2)	1 1/16 (27.0)	11/16 (17.5)	4300 (296)	2800 (192)	3500 (241)
1/2	1/2	-WG-FR8-NS8	2.09 (53.1)	0.75 (19.1)	0.40 (10.2)	1 1/16 (27.0)	7/8 (22.2)	4300 (296)	2800 (192)	3500 (241)

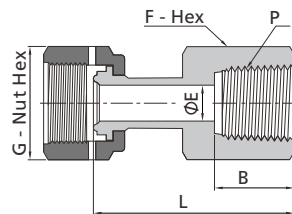

FR Welded Gland to Female NPT

FR Size (in.)	P-NPT Size	Basic Ordering Number	Dimensions, in. (mm)					Working Pressure, psig (bar)		
			L	B	E	G	F	6L	CU	NI
1/4	1/4	-WG-FR4-FNS4	1.77 (45.0)	0.59 (15.0)	0.18 (4.6)	3/4 (19.1)	3/4 (19.1)	6600 (454)	5200 (458)	6600 (454)
1/2	3/8	-WG-FR8-FNS6	1.95 (49.5)	0.59 (15.0)	0.40 (10.2)	1 1/16 (27.0)	7/8 (22.2)	4300 (296)	2800 (192)	3500 (241)
1/2	1/2	-WG-FR8-FNS8	2.18 (55.4)	0.78 (19.8)	0.40 (10.2)	1 1/16 (27.0)	1 1/16 (27.0)	4300 (296)	2800 (192)	3500 (241)

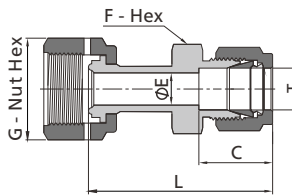

FR Welded Gland to Tube Fitting

FR Size (in.)	T-Tube O.D. (in.)	Basic Ordering Number	Dimensions, in. (mm)					Working Pressure, psig (bar)		
			L ^①	C	E	G	F	6L	CU	NI
1/4	1/4	-WG-FR4-FL4	1.94 (49.3)	0.60 (15.2)	0.18 (4.6)	3/4 (19.1)	1/2 (12.7)	8000 (551)	6400 (440)	8000 (551)
1/4	3/8	-WG-FR4-FL6	1.97 (50.0)	0.66 (16.8)	0.18 (4.6)	3/4 (19.1)	5/8 (15.9)	6500 (447)	5200 (358)	6500 (447)
1/2	1/2	-WG-FR8-FL8	2.23 (56.6)	0.90 (22.9)	0.40 (10.2)	1 1/16 (27.0)	13/16 (20.6)	4300 (296)	2800 (192)	3500 (241)

① Dimension L is with FITOK nuts finger-tight.

F-31 Face Seal Fittings

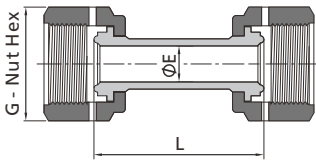

FR Welded Gland Union							
FR Size (in.)	Basic Ordering Number	Dimensions, in. (mm)			Working Pressure, psig (bar)		
		L	E	G	6L	CU	NI
1/4	-WG-FR4	1.71 (43.4)	0.18 (4.6)	3/4 (19.1)	8000 (551)	6400 (440)	8000 (551)
1/2	-WG-FR8	1.84 (46.7)	0.40 (10.2)	1 1/16 (27.0)	4300 (296)	2800 (192)	3500 (241)

Female Elbows

Basic ordering number: -LWG-FR4

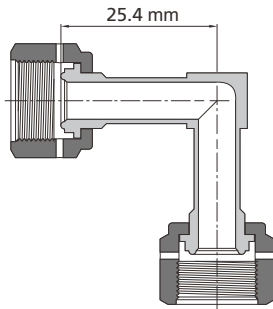

Female Tees

Basic ordering number: -TWG-FR4

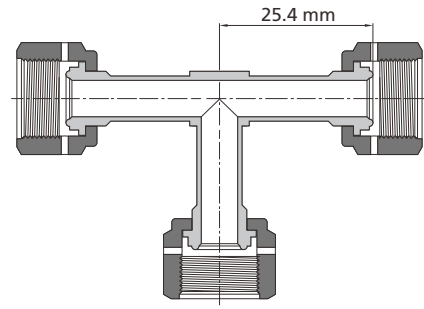

Nuts

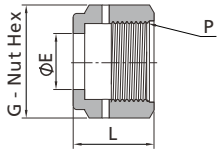

Female Nut					
FR Size (in.)	P-Thread Size and Type	Basic Ordering Number	Dimensions, in. (mm)		
			L	E	G
1/8	5/16-24 UNF	-N-FR2	0.53 (13.5)	0.21 (5.3)	7/16 (11.1)
1/4	9/16-18 UNF	-N-FR4	0.81 (20.6)	0.36 (9.1)	3/4 (19.1)
1/2	7/8-14 UNF	-N-FR8	0.88 (22.4)	0.61 (15.5)	1 1/16 (27.0)
5/8	1-14 UNS	-N-FR10	0.88 (22.4)	0.74 (18.8)	1 3/16 (30.2)
3/4	1 1/4-18 UNEF	-N-FR12	1.12 (28.4)	0.89 (22.6)	1 1/2 (38.1)
1	1 1/2-20 UN	-N-FR16	1.34 (34.0)	1.20 (30.5)	1 3/4 (44.5)

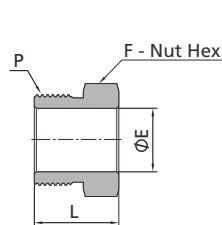

Male Nut					
FR Size (in.)	P-Thread Size and Type	Basic Ordering Number	Dimensions, in. (mm)		
			L	E	F
1/8	5/16-24 UNF	-MN-FR2	0.50 (12.7)	0.21 (5.3)	3/8 (9.5)
1/4	9/16-18 UNF	-MN-FR4	0.71 (18.0)	0.36 (9.1)	5/8 (15.9)
1/2	7/8-14 UNF	-MN-FR8	0.81 (20.6)	0.61 (15.5)	15/16 (23.8)
5/8	1-14 UNS	-MN-FR10	0.81 (20.6)	0.74 (18.8)	1 1/16 (27.0)
3/4	1 1/4-18 UNEF	-MN-FR12	1.00 (25.4)	0.89 (22.6)	1 5/16 (33.3)
1	1 1/2-20 UN	-MN-FR16	1.19 (30.2)	1.20 (30.5)	1 5/8 (41.3)

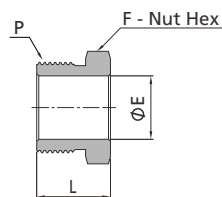

Short Male Nut					
FR Size (in.)	P-Thread Size and Type	Basic Ordering Number	Dimensions, in. (mm)		
			L	E	F
1/4	9/16-18 UNF	-MN-FR4-0.54	0.54 (13.7)	0.36 (9.1)	5/8 (15.9)
1/4	9/16-18 UNF	-MN-FR4-0.65	0.65 (16.5)	0.36 (9.1)	5/8 (15.9)

For use with Gland to Short Tube Butt Weld

Fittings
 Valves
 Regulators
 Filters
 Tubing
 Integrated Systems
 Other Products
 Technical Information

Split-Nut Assemblies

- ⦿ Convenient and flexible connection
- ⦿ Connects FR metal gasket face seal fittings with shorter weld sizes
- ⦿ Allows for seamless interchangeability between female and male threads, even when the gland is pre-welded

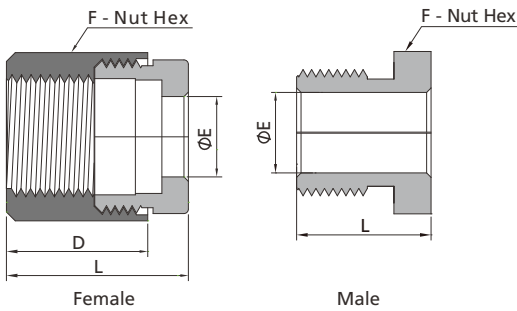

Male Thread Nut: SS-MN-FR4-SN



Female Thread Nut: SS-N-FR4-SN

Split-Nut Assemblies

FR Size (in.)	Split Nut Type	Basic Ordering Number	Dimensions, in. (mm)			
			L	E	F	D
1/4	Female	-N-FR4-SN	0.81 (20.6)	0.36 (9.1)	3/4 (19.1)	0.63 (16.0)
1/4	Male	-MN-FR4-SN	0.60 (15.2)	0.36 (9.1)	5/8 (15.9)	-

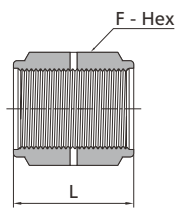

Coupling		Dimensions, in. (mm)	
FR Size (in.)	Basic Ordering Number	L	F
1/8	-BC-FR2	0.66 (16.8)	7/16 (11.1)
1/4	-BC-FR4	1.19 (30.2)	3/4 (19.1)
1/2	-BC-FR8	1.31 (33.3)	1 1/16 (27.0)
3/4	-BC-FR12	1.68 (42.7)	1 1/2 (38.1)
1	-BC-FR16	2.04 (51.8)	1 3/4 (44.5)

Plugs

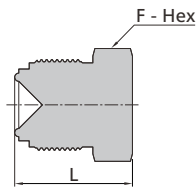

Plug

FR Size (in.)	Basic Ordering Number	Dimensions, in. (mm)	
		L	F
1/8	-PG-FR2	0.68 (17.3)	3/8 (9.5)
1/4	-PG-FR4	0.92 (23.4)	5/8 (15.9)
1/2	-PG-FR8	1.08 (27.4)	15/16 (23.8)
3/4	-PG-FR12	1.43 (36.3)	1 5/16 (33.3)
1	-PG-FR16	1.52 (38.6)	1 5/8 (41.3)

Plugs with Lanyard

- ⦿ Lanyard material: 304 SS.
- ⦿ Lanyard length: 15.2 cm.



Plug with Lanyard

FR Size (in.)	Basic Ordering Number	Dimensions, in. (mm)	
		L	F
1/4	-PG-FR4-BP	0.92 (23.4)	5/8 (15.9)
1/2	-PG-FR8-BP	1.08 (27.4)	15/16 (23.8)

Fittings

Valves

Regulators

Filters

Tubing

Integrated Systems

Other Products

Technical Information

Caps

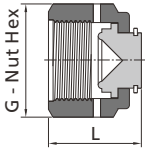

Cap			
FR Size (in.)	Basic Ordering Number	Dimensions, in. (mm)	
		L	G
1/8	-CP-FR2	0.63 (16.0)	7/16 (11.1)
1/4	-CP-FR4	0.94 (23.9)	3/4 (19.1)
1/2	-CP-FR8	1.01 (25.6)	1 1/16 (27.0)
3/4	-CP-FR12	1.29 (32.8)	1 1/2 (38.1)
1	-CP-FR16	1.54 (39.1)	1 3/4 (44.5)

Flow Restrictors

Working pressure up to: 10,000 psig (690 bar)

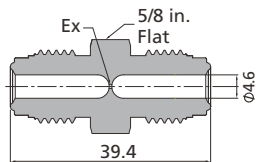

FR Body to Male FR		
Ex, in. (mm)	Ordering Number	
0.015 (0.381)	6LV-R-FR4-015	
0.017 (0.432)	6LV-R-FR4-017	
0.020 (0.508)	6LV-R-FR4-020	
0.023 (0.584)	6LV-R-FR4-023	
0.025 (0.635)	6LV-R-FR4-025	
0.026 (0.660)	6LV-R-FR4-026	
0.027 (0.686)	6LV-R-FR4-027	
0.030 (0.762)	6LV-R-FR4-030	
0.035 (0.889)	6LV-R-FR4-035	
0.040 (1.016)	6LV-R-FR4-040	
0.045 (1.143)	6LV-R-FR4-045	
0.050 (1.270)	6LV-R-FR4-050	
0.055 (1.397)	6LV-R-FR4-055	
0.060 (1.529)	6LV-R-FR4-060	
0.065 (1.651)	6LV-R-FR4-065	
0.070 (1.778)	6LV-R-FR4-070	
0.075 (1.905)	6LV-R-FR4-075	
0.080 (2.032)	6LV-R-FR4-080	
0.085 (2.159)	6LV-R-FR4-085	
0.090 (2.286)	6LV-R-FR4-090	
0.093 (2.362)	6LV-R-FR4-093	
0.095 (2.413)	6LV-R-FR4-095	
0.100 (2.540)	6LV-R-FR4-100	

Note: Integral FR fittings must remain stationary during installation and should be used in conjunction with rotating nuts and glands.

Caps with Lanyard

- Lanyard material: 304 SS.
- Lanyard length: 15.2 cm.



Cap with Lanyard			
FR Size (in.)	Basic Ordering Number	Dimensions, in. (mm)	
		L	G
1/4	-CP-FR4-BP	0.94 (23.9)	3/4 (19.1)
1/2	-CP-FR8-BP	1.01 (25.6)	1 1/16 (27.0)

Locking Device

- To help prevent unintentional disassembly of FR connections.
- Used for FITOK FR metal gasket face seal assemblies with standard male and female nuts.



Locking Device		
FR Size (in.)	Ordering Number	
1/4	S4-FR4-LD	
1/2	S4-FR8-LD	

Gaskets

- Unplated 316L SS and nickel gaskets are electropolished and conform to the Ultra High Purity Process (FC-03), with a maximum helium leak rate of 4×10^{-11} std cm³/s.
- Silver-plated 316L SS and nickel gaskets conform to the Special Cleaning and Packaging Process (FC-02), with a maximum helium leak rate of 4×10^{-9} std cm³/s. To order, remove the "-UP" suffix from the ordering number.
- Copper gaskets are neither plated nor electropolished and conform to the Special Cleaning and Packaging Process (FC-02), with a maximum helium leak rate of 4×10^{-9} std cm³/s.

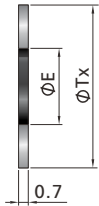

Nonretained Unplated (UP)			
FR Size (in.)	Basic Ordering Number	Dimensions, in. (mm)	
		Tx	E
1/8	-GT-FR2-UP	0.26 (6.6)	0.09 (2.3)
1/4	-GT-FR4-UP	0.47 (11.9)	0.22 (5.6)
1/2	-GT-FR8-UP	0.78 (19.8)	0.44 (11.2)
5/8	-GT-FR10-UP	0.91 (23.1)	0.58 (14.7)
3/4	-GT-FR12-UP	1.14 (29.0)	0.66 (16.8)
1	-GT-FR16-UP	1.40 (35.6)	0.89 (22.6)

Gaskets are used without retainers.

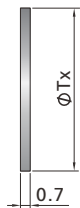

Blind Gaskets Unplated (UP)		
FR Size (in.)	Basic Ordering Number	Dimensions, in. (mm)
		Tx
1/8	-GT-FR2-B-UP	0.26 (6.6)
1/4	-GT-FR4-B-UP	0.47 (11.9)
1/2	-GT-FR8-B-UP	0.78 (19.8)
5/8	-GT-FR10-B-UP	0.91 (23.1)
3/4	-GT-FR12-B-UP	1.14 (29.0)
1	-GT-FR16-B-UP	1.40 (35.6)

Blind gasket retainer assemblies are available, please contact FITOK Group for more details.

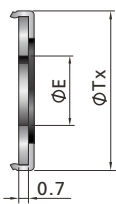

Gasket Retainer Assemblies Unplated (UP)			
FR Size (in.)	Basic Ordering Number	Dimensions, mm	
		Tx	E
1/4	-GT-FR4-A-UP	0.50 (12.7)	0.24 (6.1)
1/2	-GT-FR8-A-UP	0.78 (19.7)	0.44 (11.2)
3/4	-GT-FR12-A-UP	1.14 (29.0)	0.66 (16.8)
1	-GT-FR16-A-UP	1.40 (35.6)	0.89 (22.6)

- Gaskets are used with retainers.
- Retainer material is 316L SS.
- Retainers are available in different colors, please contact FITOK Group for more details.

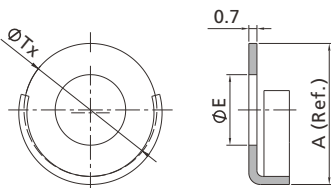

Side-Load Retainer Unplated (UP)				
FR Size (in.)	Basic Ordering Number	Dimensions, in. (mm)		
		Tx	E	A (Ref.)
1/4	-GT-FR4-AS-UP	0.45 (11.4)	0.24 (6.1)	0.48 (12.2)
1/2	-GT-FR8-AS-UP	0.74 (18.8)	0.43 (11.0)	0.77 (19.5)

- Gaskets are only available in 316L SS and nickel.
- Silver-plated gaskets are not available.

Fittings

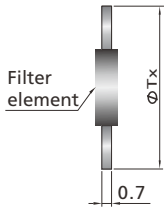

Snubber Gaskets Unplated (UP)		
FR Size (in.)	Basic Ordering Number	Dimensions, mm
		Tx
1/4	-GT-FR4-UP-**M	0.47 (11.9)
1/2	-GT-FR8-UP-**M	0.78 (19.8)
3/4	-GT-FR12-UP-**M	1.14 (29.0)
1	-GT-FR16-UP-**M	1.40 (35.6)

1. Add the designator of filtration accuracy as a suffix to the basic ordering number to get the complete ordering number. Example: For 1/4" 316L SS snubber gaskets with filtration accuracy of 0.5 μ m, the ordering number is 6L-GT-FR4-UP-05M.
2. Snubber gaskets with filtration accuracy of 0.5 to 60 μ m for 1/4 through 1 in. FR fittings are available.

Valves

Regulators

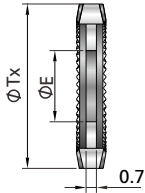

Knurled Unplated (UP)			
FR Size (in.)	Basic Ordering Number	Dimensions, in.(mm)	
		Tx	E
1/4	-GT-FR4-KN-A-UP	0.5(12.7)	0.22(5.5)

1. Used to prevent nuts from loosening from vibration.
2. General 316L SS or Nickle gaskets are tightened with 1/8 turn, while knurled gaskets are assembled by 3/8 turn.

Filters

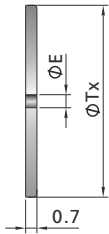

Restriction Gaskets Unplated (UP)			
FR Size (in.)	Basic Ordering Number	Size in. (mm)	
		Tx	E
1/8	-GT-FR2-UP-ID***	0.26 (6.6)	***
1/4	-GT-FR4-UP-ID***	0.47 (11.9)	***
1/2	-GT-FR8-UP-ID***	0.78 (19.8)	***
3/4	-GT-FR12-UP-ID***	1.14 (29.0)	***
1	-GT-FR16-UP-ID***	1.40 (35.6)	***

1. Gaskets are used without retainers.
2. *** indicates restriction orifice sizes, such as 0.3, which means an orifice size of ϕ 0.3 mm (only in mm). Example: 6L-GT-FR4-UP-ID0.3. For specific selection details, please contact FITOK.

Tubing

Integrated Systems

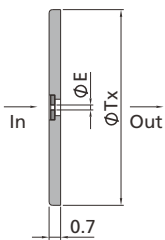

Ruby Orifice Restriction Gaskets Unplated (UP)			
FR Size (in.)	Basic Ordering Number	Size in. (mm)	
		Tx	E
1/8	-GT-FR2-UP-R***	0.26 (6.6)	***
1/4	-GT-FR4-UP-R***	0.47 (11.9)	***
1/2	-GT-FR8-UP-R***	0.78 (19.8)	***

1. Gaskets are used without retainers.
2. *** indicates ruby orifice sizes, such as 012, which means an orifice size of 0.012" (012/1000") (only in inch). Example: 6L-GT-FR4-UP-R012. Orifice sizes range from 0.0015" to 0.035". Please note that the orifice sizes are not available in continuous increments. For specific selection details, please contact FITOK.
3. When using the ruby orifice restriction gasket, it is recommended that the ruby side faces the gas inlet to enable more stable and uniform flow.
4. The maximum working pressure of the ruby orifice restriction gasket is 145 psig (10 bar). For use in working conditions with higher pressure requirements, please contact FITOK.

Other Products

Technical Information

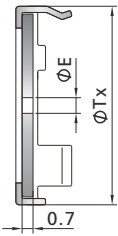

Restriction Gasket Retainer Assemblies Unplated (UP)			
FR Size (in.)	Basic Ordering Number	Size in. (mm)	
		Tx	E
1/4	-GT-FR4-A-UP-ID***	0.50 (12.7)	***
1/2	-GT-FR8-A-UP-ID***	0.78 (19.7)	***
3/4	-GT-FR12-A-UP-ID***	1.14 (29.0)	***
1	-GT-FR16-A-UP-ID***	1.40 (35.6)	***

1. Gaskets are used with retainers.
2. Retainer material is 316L SS.
3. ** indicates restriction orifice sizes, such as 0.3, which means an orifice size of Φ 0.3 mm (only in mm). Example: 6L-GT-FR4-A-UP-ID0.3. For more size options, please contact FITOK.

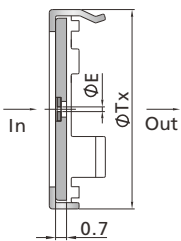

Ruby Orifice Restriction Gasket Retainer Assemblies Unplated (UP)			
FR Size (in.)	Basic Ordering Number	Size in. (mm)	
		Tx	E
1/4	-GT-FR4-A-UP-R***	0.50 (12.7)	***

1. Gaskets are used with retainers.
2. Retainer material is 316L SS.
3. *** indicates ruby orifice sizes, such as 012, which means an orifice size of Φ 0.012" (012/1000") (only in inch). Example: 6L-GT-FR4-A-UP-R012. For more size options, please contact FITOK.
4. When using the ruby orifice restriction gasket, it is recommended that the ruby side faces the gas inlet to enable more stable and uniform flow.
5. The maximum working pressure of the ruby orifice restriction gasket is 145 psig (10 bar). For use in working conditions with higher pressure requirements, please contact FITOK.

High-Flow Connections - "H" Type FR Fittings

"H" type FR Fittings connections with high flow capacity are compatible with regular FR connections. Gasket retainer assemblies are recommended to minimize flow resistance.

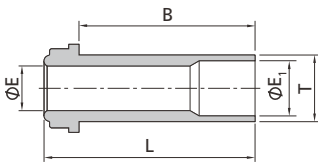

HFR Gland to Tube Butt Weld										
FR Size (in.)	T-Tube O.D. (in.)	Nominal Wall Thickness (in.)	Basic Ordering Number	Dimensions, in. (mm)				Working Pressure, psig (bar)		
				L	B	E	E ₁	6L	CU	NI
1/4	3/8	0.035	-G-HFR4-TB6-0.60	0.60 (15.2)	0.41 (10.4)	0.25 (6.4)	0.31 (7.9)	3300 (227)	3300 (227)	3300 (227)
1/4	3/8	0.035	-G-HFR4-TB6-1.19	1.19 (30.2)	1.00 (25.4)	0.25 (6.4)	0.31 (7.9)	3300 (227)	3300 (227)	3300 (227)
1/4	3/8	0.035	-G-HFR4-TB6-1.31	1.31 (33.3)	1.12 (28.4)	0.25 (6.4)	0.31 (7.9)	3300 (227)	3300 (227)	3300 (227)

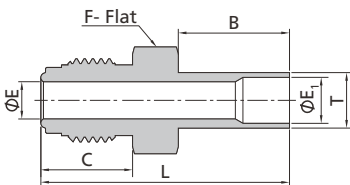

HFR Body to Tube Butt Weld												
FR Size (in.)	T-Tube O.D. (in.)	T-Tube Wall Thickness (in.)	Basic Ordering Number	Dimensions, in. (mm)					Working Pressure, psig (bar)			
				L	B	C	E	E ₁	F	6L	CU	NI
1/4	3/8	0.035	-CW-HFR4-TB6	1.68 (42.7)	0.75 (19.1)	0.62 (15.7)	0.25 (6.4)	0.31 (7.9)	5/8 (15.9)	3300 (227)	3300 (227)	3300 (227)

Note: Integral FR fittings must remain stationary during installation and should be used in conjunction with rotating nuts and glands.

F-37 Face Seal Fittings

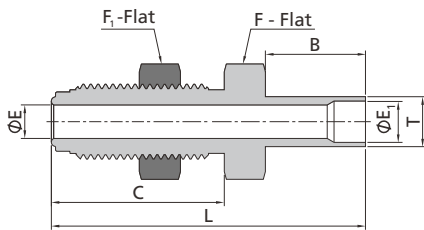

HFR Bulkhead Body to Tube Butt Weld

FR Size (in.)	T-Tube O.D. (in.)	T-Tube Wall Thickness (in.)	Basic Ordering Number	Dimensions, in. (mm)							Panel Hole Dia	Max. Panel Thickness	Working Pressure, psig (bar)		
				L	B	C	E	E ₁	F	F ₁			6L	CU	NI
1/4	3/8	0.035	-BW-HFR4-TB6	2.36 (59.9)	0.75 (19.1)	1.30 (33.0)	0.25 (6.4)	0.31 (7.9)	3/4 (19.1)	3/4 (19.1)	19/32 (15.0)	0.44 (11.2)	3300 (227)	3300 (227)	3300 (227)

Note: Integral FR fittings must remain stationary during installation and should be used in conjunction with rotating nuts and glands.

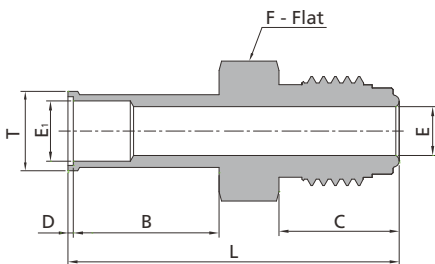

HFR Body to Automatic Tube Weld

FR Size (in.)	Tube Size (in.)	Basic Ordering Number	Dimensions, in. (mm)									Working Pressure, psig (bar)		
			L	B	C	D	E	E ₁	F	T	6L	CU	NI	
1/4	3/8	-AW-HFR4-TB6	1.71 (43.4)	0.75 (19.1)	0.62 (15.7)	0.03 (0.8)	0.25 (6.4)	0.31 (7.9)	5/8 (15.9)	0.41 (10.4)	3300 (227)	3300 (227)	3300 (227)	

Note: Integral FR fittings must remain stationary during installation and should be used in conjunction with rotating nuts and glands.

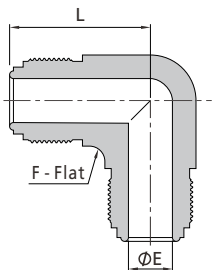

HFR Body Union Elbow

FR Size (in.)	Basic Ordering Number	Dimensions, in. (mm)			Working Pressure, psig (bar)		
		L	E	F	6L	CU	NI
1/4	-LU-HFR4	1.07 (27.2)	0.25 (6.4)	1/2 (12.7)	10000 (690)	6400 (440)	8000 (551)

Note: Integral FR fittings must remain stationary during installation and should be used in conjunction with rotating nuts and glands.

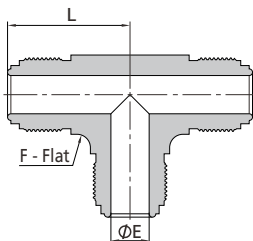

HFR Body Union Tee

FR Size (in.)	Basic Ordering Number	Dimensions, in. (mm)			Working Pressure, psig (bar)		
		L	E	F	6L	CU	NI
1/4	-TTT-HFR4	1.07 (27.2)	0.25 (6.4)	1/2 (12.7)	10000 (690)	6400 (440)	8000 (551)

Note: Integral FR fittings must remain stationary during installation and should be used in conjunction with rotating nuts and glands.

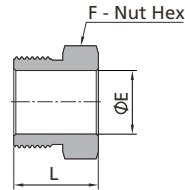
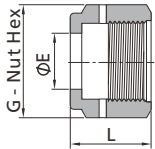

HFR Female Nut		Dimensions, in. (mm)		
FR Size (in.)	Basic Ordering Number	L	E	G
		1/4	-N-HFR4-9.9	0.81 (20.6)
1/4	-N-HFR4-11.7	0.81 (20.6)	0.46 (11.7)	3/4 (19.1)

HFR Male Nut		Dimensions, in. (mm)		
FR Size (in.)	Basic Ordering Number	L	E	F
		1/4	-MN-HFR4	0.71 (18.0)

- Fittings
- Valves
- Regulators
- Filters
- Tubing
- Integrated Systems
- Other Products
- Technical Information

L-Ring Face Seal Fittings

TFO Series

Features

- ⦿ Reduced internal entrapment
- ⦿ Lubricant-free L-ring seal
- ⦿ Controlled L-ring extrusion to prevent over-tightening
- ⦿ Butt weld connection to ensure the system unhindered
- ⦿ Standard surface roughness finished to an average of Ra 20 µin. (0.51 µm)
- ⦿ Sizes range from 1/4" to 1"
- ⦿ Each fitting marked with size, material and heat number



Technical Data

⦿ Materials

Material	Designator
316 SS	SS
316L SS	6L

⦿ Working Temperature

Temperature ranges for TFO fittings are restricted by the L-ring materials.

Material	Designator	Working Temperature
PTFE	T	- 50°F to 450°F (- 45°C to 232°C)

⦿ Working Pressure @ 100°F (37°C)

Tube O.D.	Working Pressure psig (bar)
1/4 in.	2500 (172)
1/2 in.	2000 (137)
3/4 in.	1500 (103)
1 in.	
12 mm	2000 (137)

⦿ Weld End Tube O.D. and Wall Thickness

Fractional		Metric	
Tube O.D. in.	Wall Thickness in.	Tube O.D. mm	Wall Thickness mm
1/8	0.028	6	1.0
1/4	0.035	8	1.0
3/8	0.035	10	1.0
1/2	0.049	12	1.0
3/4	0.065	18	1.5
1	0.065		
1 1/2	0.065		
2	0.065		

For other sizes or wall thicknesses of welded ports, please contact FITOK Group or our authorized distributors.

Process Specification

Item	Process Specification	Standard Cleaning and Packaging Process (FC-01) Special Cleaning and Packaging Process (FC-02)
	Material	316 SS, 316L SS
Wetted Surface Roughness	Ra 20 µin. (0.5µm)	
Polishing Process	Machine finished	

Testing

Every TFO fitting is helium leak tested to a maximum allowable leak rate of 4×10^{-9} std cm³/s.

Ordering Information

- ⦿ Each component can be ordered separately.
 - ⦿ Add the material designator as a prefix, cleaning and packaging designator as a suffix to the basic ordering number to get the complete ordering number.
 - ⦿ Cleaning and Packaging
 - a. Standard Cleaning and Packaging Process (FC-01) for general industrial procedures. No suffix is needed.
 - b. Special Cleaning and Packaging Process (FC-02), to ensure compliance with product cleanliness requirement as stated in ASTM G93 Level C. Add "-F2" as a suffix when needed.
- Example: For 316L SS standard 1/4" gland with Special Cleaning and Packaging Process (FC-02), the ordering number is 6L-G-TFO4-TB4-F2.

Installation Instructions

1. Assemble the gland, nut and gasket as below. Finger tight the nut.
2. Tighten the nut 1/8 turn with a wrench while holding the fitting body steady.

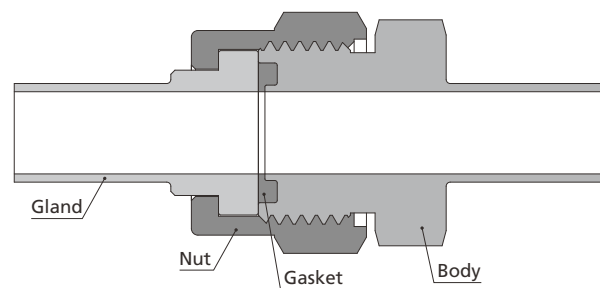

Cautions

- ⦿ Dimensions are for reference only and are subject to change.
- ⦿ Inspect the L-ring each time the groove housing is dismantled.
- ⦿ Before welding the body, the L-ring should be removed to prevent possible damages.
- ⦿ Tungsten Inert Gas Welding (TIG) is recommended.
- ⦿ Do not loosen or tighten fittings when system is pressurized.

Glands

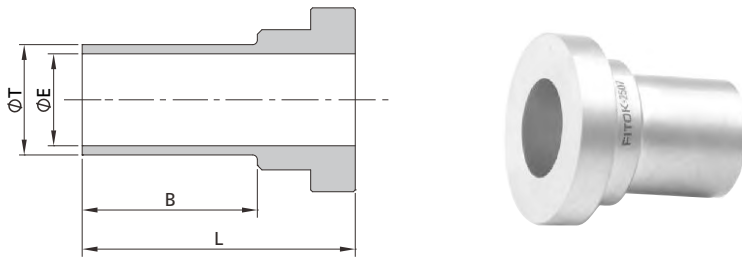

Fractional				Dimensions, in. (mm)		
TFO Size (in.)	T-Tube O.D. (in.)	Wall Thickness (in.)	Basic Ordering Number	L	B	E
1/4	1/4	0.035	-G-TFO4-TB4	0.67 (17.0)	0.25 (6.4)	0.18 (4.6)
1/4	1/4	0.035	-G-TFO4-TB4-12	1.17 (29.7)	0.75 (19.1)	0.18 (4.6)
1/2	1/2	0.049	-G-TFO8-TB8	1.17 (29.7)	0.75 (19.1)	0.40 (10.2)
1/2	1/2	0.065	-G-TFO8-TB8×065	1.17 (29.7)	0.75 (19.1)	0.37 (9.4)
3/4	3/4	0.065	-G-TFO12-TB12	1.24 (31.5)	0.75 (19.1)	0.62 (15.7)
1	1	0.065	-G-TFO16-TB16	1.45 (36.8)	0.96 (24.4)	0.87 (22.1)

Metric				Dimensions, in. (mm)		
TFO Size (in.)	T-Tube O.D. (mm)	Wall Thickness (mm)	Basic Ordering Number	L	B	E
1/2	12	1	-G-TFO8-MTB12	1.17 (29.7)	0.75 (19.1)	0.39 (10.0)

Nuts

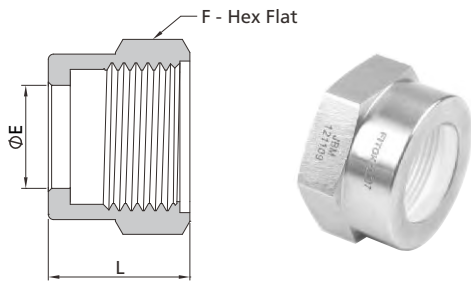

Fractional		Dimensions, in. (mm)		
TFO Size (in.)	Basic Ordering Number	L	E	F
1/4	-N-TFO4	0.75 (19.1)	0.39 (9.9)	11/16 (17.5)
1/2	-N-TFO8	0.84 (21.3)	0.61 (15.5)	1 (25.4)
3/4	-N-TFO12	0.90 (22.9)	0.94 (23.9)	1 1/2 (38.1)
1	-N-TFO16	0.90 (22.9)	1.25 (31.8)	1 3/4 (44.5)

Tube Butt Weld Bodies

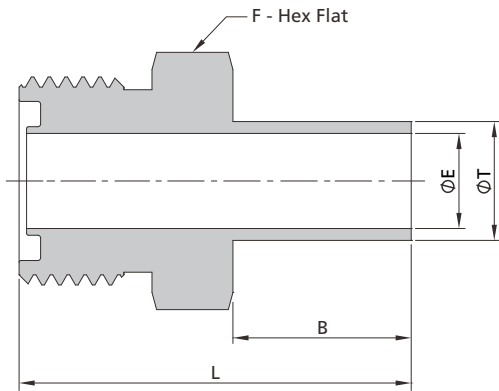

Fractional				Dimensions, in. (mm)			
TFO Size (in.)	T-Tube OD. (in.)	Wall Thickness (in.)	Basic Ordering Number	L	B	E	F
1/4	1/4	0.035	-CW-TFO4-TB4	1.03 (26.2)	0.25 (6.4)	0.18 (4.6)	5/8 (15.9)
1/4	1/4	0.035	-CW-TFO4-TB4-12	1.53 (38.9)	0.75 (19.1)	0.18 (4.6)	5/8 (15.9)
1/2	1/2	0.049	-CW-TFO8-TB8	1.65 (41.9)	0.75 (19.1)	0.40 (10.2)	15/16 (23.8)
1/2	1/2	0.065	-CW-TFO8-TB8x065	1.65 (41.9)	0.75 (19.1)	0.37 (9.4)	15/16 (23.8)
3/4	3/4	0.065	-CW-TFO12-TB12	1.75 (44.4)	0.75 (19.1)	0.62 (15.7)	1 5/16 (33.3)
1	1	0.065	-CW-TFO16-TB16	1.99 (50.5)	0.96 (24.4)	0.87 (22.1)	1 5/8 (41.3)

Metric				Dimensions, in. (mm)			
TFO Size (in.)	T-Tube OD. (mm)	Wall Thickness (mm)	Basic Ordering Number	L	B	E	F
1/2	12	1	-CW-TFO8-MTB12	1.65 (41.9)	0.75 (19.1)	0.39 (10.0)	15/16 (23.8)

L-Ring Seal

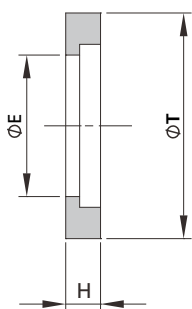

Fractional		Dimensions, in. (mm)		
TFO Size (in.)	Basic Ordering Number	T	E	H
1/4	-GT-TFO4	0.38 (9.6)	0.18 (4.6)	0.07 (1.8)
1/2	-GT-TFO8	0.64 (16.2)	0.40 (10.2)	0.10 (2.5)
3/4	-GT-TFO12	0.92 (23.4)	0.62 (15.7)	0.10 (2.5)
1	-GT-TFO16	1.30 (33.0)	0.87 (22.1)	0.14 (3.6)

Add the designator of L-ring material in page F-39 as a prefix to the basic ordering number to get the complete ordering number.
Example: T-GT-TFO4

O-Ring Face Seal Fittings

FO Series

Fittings

Valves

Regulators

Filters

Tubing

Integrated Systems

Other Products

Technical Information

Features

- ⦿ O-ring seal to provide perfect leak-tight service for working conditions from critical vacuum to high pressure
- ⦿ Smooth finish on gland face to ensure positive seal
- ⦿ Test ports at nut for easy leak testing
- ⦿ Easy installation and maintenance
- ⦿ Silver-plated female threads
- ⦿ Sizes range from 1/8" to 1"
- ⦿ Every gland and body marked with size, material and heat number



Technical Data

⦿ Thread Specifications

Thread Type	Specification
NPT	ASME B1.20.1, SAE AS71051
Unified (SAE)	ASME B1.1, SAE J475

⦿ Materials

Material	Designator
316 SS	SS
316L SS	6L

⦿ Weld End Tube O.D. and Wall Thickness

Fractional		Metric	
Tube O.D. in.	Wall Thickness in.	Tube O.D. mm	Wall Thickness mm
1/8	0.028	6	1.0
1/4	0.035	8	1.0
3/8	0.035	10	1.0
1/2	0.049	12	1.0
3/4	0.049	18	1.5
1	0.065		
1 1/2	0.065		
2	0.065		

For other sizes or wall thicknesses of welded ports, please contact FITOK Group or our authorized distributors.

⦿ Working Pressure

Working pressures shown in the Catalog are calculated according to ASME B31.3 and B31.1 at ambient temperature.

⦿ Working Temperature

Temperature ranges for FO fittings are restricted by the materials of gaskets and O-rings.

Port	Seal Material		Material Designator	Hardness	Overall Designator	Working Temperature
Male SAE/MS	O-ring	Fluorocarbon FKM (90 durometer)	VI	9	VI9	-10 °F to 400 °F (-23 °C to 204 °C)
		Fluorocarbon FKM (70 durometer)	VI	7	VI7	-10 °F to 400 °F (-23 °C to 204 °C)
FO	O-ring	FFKM (70 durometer)	Z	7	Z7	-22 °F to 550 °F (-30 °C to 287 °C)
		Buna N (70 durometer)	BN	7	BN7	-22 °F to 250 °F (-30 °C to 121 °C)
		EPDM (70 durometer)	E	7	E7	-50 °F to 300 °F (-45 °C to 148 °C)
		Gasket	PTFE	T	N/A	T

The Male SAE/MS port uses a fluorocarbon FKM O-ring (90 durometer) by default, with an overall designator of VI9.

For O-ring made from other materials, please contact FITOK.

The FO port uses a Fluorocarbon FKM (70 durometer) O-ring by default, with an overall designator of VI7. Various other materials are available, as shown in the table above. For O-ring in materials not listed, please contact FITOK.

Process Specification

Item	Process Specification	Standard Cleaning and Packaging Process (FC-01) Special Cleaning and Packaging Process (FC-02)
Material		316 SS, 316L SS
Wetted Surface Roughness		Ra 20 $\mu\text{in.}$ (0.5 μm)
Polishing Process		Machine finished

Testing

Every FO fitting is helium leak tested to a maximum allowable leak rate of 4×10^{-9} std cm^3/s .

Ordering Information

- ⦿ Each component can be ordered separately.
- ⦿ Cleaning and Packaging
 - a. Standard Cleaning and Packaging Process (FC-01): No suffix is needed.
 - b. Special Cleaning and Packaging Process (FC-02): Ensure compliance with product cleanliness requirement as stated in ASTM G93 Level C. To order, add "-F2" as a suffix.
- ⦿ Add the fitting body material designator as a prefix and the cleaning and packaging designator as a suffix to the basic ordering number to get the complete ordering number. Example: 6L-CM-FO8-ST7-F2 or SS-CM-FO8-ST7
- ⦿ The FO port uses a Fluorocarbon FKM (70 durometer) O-ring by default. To specify O-rings made from other materials, insert the corresponding material designator for the O-ring or gasket between the model number and the cleaning grade designator. Example: 6L-CM-FO8-ST7-E-F2 or SS-CM-FO8 ST7-T

Installation Instructions

1. Assemble the gland, nut, O-ring and body as below. Finger tight the nut.
2. Tighten the nut 1/8 - 1/4 turn with a wrench while holding the fitting body steady, until there is a sharp rise in torque.

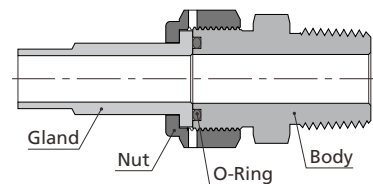

Cautions

- ⦿ Dimensions are for reference only and are subject to change.
- ⦿ Check the O-ring every time the fitting is disassembled and replace the O-ring if there is any damage.
- ⦿ Before welding the body, the O-ring should be removed to prevent possible damages.
- ⦿ Tungsten Inert Gas Welding (TIG) is recommended.
- ⦿ Do not loosen or tighten fittings when system is pressurized.

Glands

Fittings

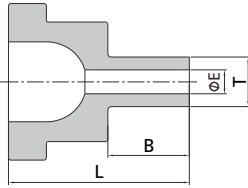

FO Gland to Tube Butt Weld							
FO Size (in.)	T-Tube O.D. (in.)	T-Tube Wall Thickness (in.)	Basic Ordering Number	Dimensions, in. (mm)			Working Pressure psig (bar)
				L	B	E	
1/4	1/8	0.028	-G-FO4-TB2	0.77 (19.6)	0.28 (7.1)	0.07 (1.8)	11200 (771)
1/4	1/4	0.065	-G-FO4-TB4×065	1.12 (28.4)	0.41 (10.4)	0.12 (3.0)	11200 (771)
1/2	1/4	0.065	-G-FO8-TB4×065	0.91 (23.1)	0.41 (10.4)	0.12 (3.0)	11200 (771)
1/2	3/8	0.073	-G-FO8-TB6×073	0.84 (21.3)	0.41 (10.4)	0.23 (5.8)	8200 (564)
1/2	1/2	0.085	-G-FO8-TB8×085	1.06 (26.9)	0.50 (12.7)	0.33 (8.4)	7500 (516)

Valves

Regulators

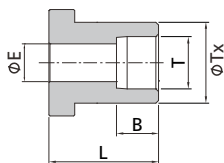

FO Gland to Tube Socket Weld							
FO Size (in.)	T-Tube O.D. (in.)	Basic Ordering Number	Dimensions, in. (mm)				Working Pressure psig (bar)
			L	B	E	Tx	
1/8	1/8	-G-FO2-TS2	0.77 (19.6)	0.10 (2.5)	0.09 (2.3)	0.38 (9.7)	15400 (1061)
1/4	1/4	-G-FO4-TS4	0.77 (19.6)	0.28 (7.1)	0.18 (4.6)	0.38 (9.7)	6800 (468)
3/8	3/8	-G-FO6-TS6	0.81 (20.6)	0.31 (7.9)	0.28 (7.1)	0.60 (15.2)	8100 (558)
1/2	1/2	-G-FO8-TS8	0.81 (20.6)	0.38 (9.7)	0.40 (10.2)	0.60 (15.2)	3000 (206)
3/4	3/4	-G-FO12-TS12	0.94 (23.9)	0.44 (11.2)	0.62 (15.7)	0.92 (23.4)	3700 (255)
1	1	-G-FO16-TS16	0.98 (24.9)	0.62 (15.7)	0.87 (22.1)	1.19 (30.2)	3000 (206)

Filters

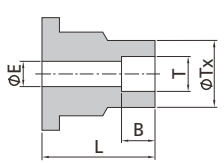

FO Gland to Tube Socket Weld Reducing							
FO Size (in.)	T-Tube O.D. (in.)	Basic Ordering Number	Dimensions, in. (mm)				Working Pressure psig (bar)
			L	B	E	Tx	
1/4	1/8	-G-FO4-TS2	0.77 (19.6)	0.10 (2.5)	0.09 (2.3)	0.29 (7.4)	12600 (868)
1/2	1/4	-G-FO8-TS4	0.81 (20.6)	0.28 (7.1)	0.18 (4.6)	0.48 (12.2)	10700 (737)

Tubing

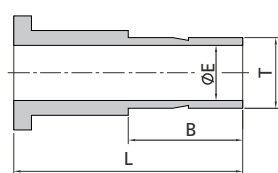

FO Gland to Tube Port							
FO Size (in.)	T-Tube O.D. (in.)	Basic Ordering Number	Dimensions, in. (mm)			Working Pressure psig (bar)	
			L	B	E		
1/4	1/4	-G-FO4-FT4	1.31 (33.3)	0.64 (16.3)	0.18 (4.6)	10200 (702)	
1/2	3/8	-G-FO8-FT6	1.38 (35.1)	0.70 (17.8)	0.27 (6.8)	6500 (447)	
1/2	1/2	-G-FO8-FT8	1.62 (41.1)	0.96 (24.4)	0.37 (9.3)	6700 (461)	
3/4	3/4	-G-FO12-FT12	1.80 (45.7)	1.02 (25.9)	0.58 (14.7)	5800 (399)	
1	1	-G-FO16-FT16	2.05 (52.1)	1.30 (33.0)	0.80 (20.3)	4700 (323)	

Integrated Systems

Other Products

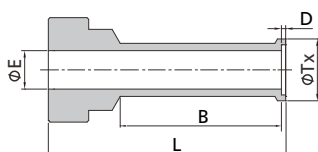

FO Gland to Automatic Tube Weld									
FO Size (in.)	Tube O.D. (in.)	Wall Thickness (in.)	Basic Ordering Number	Dimensions, in. (mm)					Working Pressure psig (bar)
				L	B	D	E	Tx	
1/4	1/4	0.035	-G-FO4-TB4A	1.12 (28.4)	0.78 (19.8)	0.02 (0.5)	0.18 (4.6)	0.29 (7.4)	5100 (351)
1/2	3/8	0.035	-G-FO8-TB6A	1.13 (28.7)	0.79 (20.0)	0.03 (0.8)	0.31 (7.9)	0.41 (10.4)	3300 (227)
1/2	1/2	0.049	-G-FO8-TB8A	1.14 (29.0)	0.80 (20.3)	0.04 (1.0)	0.40 (10.2)	0.55 (14.0)	3500 (241)
3/4	3/4	0.049	-G-FO12-TB12A	1.20 (30.5)	0.80 (20.3)	0.04 (1.0)	0.65 (16.5)	0.80 (20.3)	2200 (151)
1	1	0.065	-G-FO16-TB16A	1.41 (35.8)	1.00 (25.4)	0.04 (1.0)	0.87 (22.1)	1.06 (26.9)	2200 (151)

Technical Information

Welded Glands

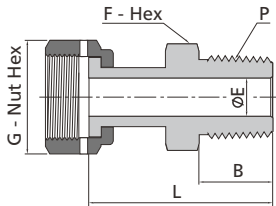

FO Welded Gland to Male NPT

FO Size (in.)	P-NPT Size	Basic Ordering Number	Dimensions, in. (mm)					Working Pressure psig (bar)
			L	B	E	G	F	
1/4	1/4	-WG-FO4-NS4	1.59 (40.4)	0.56 (14.2)	0.18 (4.6)	11/16 (17.5)	5/8 (15.9)	9800 (675)
1/2	3/8	-WG-FO8-NS6	1.67 (42.4)	0.56 (14.2)	0.40 (10.2)	1 (25.4)	15/16 (23.8)	5600 (385)
1/2	1/2	-WG-FO8-NS8	1.87 (47.5)	0.75 (19.1)	0.40 (10.2)	1 (25.4)	15/16 (23.8)	5600 (385)
3/4	3/4	-WG-FO12-NS12	2.03 (51.6)	0.75 (19.1)	0.62 (15.7)	1 1/2 (38.1)	1 1/16 (27.0)	3900 (268)
1	1	-WG-FO16-NS16	2.36 (59.9)	0.94 (23.9)	0.87 (22.1)	1 3/4 (44.5)	1 5/8 (41.3)	2900 (199)

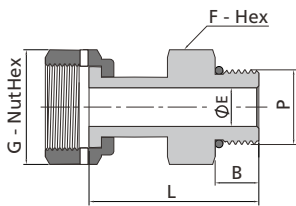

FO Welded Gland to SAE/MS Thread

FO Size (in.)	P-SAE/MS Thread Size	Basic Ordering Number	Dimensions, in. (mm)					Working Pressure psig (bar)
			L	B	E	G	F	
1/4	7/16-20	-WG-FO4-ST7	1.54 (39.1)	0.36 (9.1)	0.18 (4.6)	11/16 (17.5)	9/16 (14.3)	4500 (310)
1/2	9/16-18	-WG-FO8-ST9	1.64 (41.7)	0.39 (9.9)	0.40 (10.2)	1 (25.4)	11/16 (17.5)	4500 (310)
1/2	3/4-16	-WG-FO8-ST12	1.71 (43.4)	0.45 (11.2)	0.40 (10.2)	1 (25.4)	7/8 (22.2)	4500 (310)
3/4	1 1/16-12	-WG-FO12-ST17	2.07 (52.6)	0.59 (15.0)	0.62 (15.7)	1 1/2 (38.1)	1 1/4 (31.8)	3600 (248)
1	1 5/16-12	-WG-FO16-ST21	2.17 (55.1)	0.59 (15.0)	0.87 (22.1)	1 3/4 (44.5)	1 1/2 (38.1)	2900 (199)

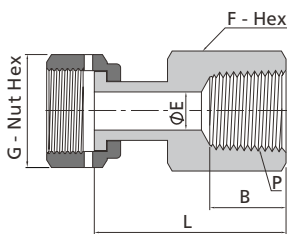

FO Welded Gland to Female NPT

FO Size (in.)	P-NPT Size	Basic Ordering Number	Dimensions, in. (mm)					Working Pressure psig (bar)
			L	B	E	G	F	
1/4	1/4	-WG-FO4-FNS4	1.57 (39.9)	0.59 (15.0)	0.18 (4.6)	11/16 (17.5)	3/4 (19.1)	6600 (454)
1/2	3/8	-WG-FO8-FNS6	1.73 (43.9)	0.59 (15.0)	0.40 (10.2)	1 (25.4)	7/8 (22.2)	5300 (365)
1/2	1/2	-WG-FO8-FNS8	1.96 (49.8)	0.78 (19.8)	0.40 (10.2)	1 (25.4)	1 1/16 (27.0)	4900 (337)
3/4	3/4	-WG-FO12-FNS12	2.12 (53.8)	0.81 (20.6)	0.62 (15.7)	1 1/2 (38.1)	1 5/16 (33.3)	4000 (275)
1	1	-WG-FO16-FNS16	2.29 (58.2)	1.00 (25.4)	0.87 (22.1)	1 3/4 (44.5)	1 5/8 (41.3)	3000 (206)

Fittings

Valves

Regulators

Filters

Tubing

Integrated Systems

Other Products

Technical Information

F-47 Face Seal Fittings

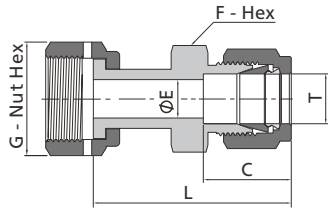

FO Welded Gland to Tube Fitting

FO Size (in.)	T-Tube O.D. (in.)	Basic Ordering Number	Dimensions, in. (mm)					Working Pressure psig (bar)
			L	C	E	G	F	
1/4	1/4	-WG-FO4-FL4	1.74 (44.2)	0.60 (15.2)	0.18 (4.6)	11/16 (17.5)	1/2 (12.7)	10200 (702)
1/2	3/8	-WG-FO8-FL6	1.87 (47.5)	0.66 (16.8)	0.28 (7.1)	1 (25.4)	5/8 (15.9)	5800 (399)
1/2	1/2	-WG-FO8-FL8	2.01 (51.1)	0.90 (22.9)	0.40 (10.2)	1 (25.4)	13/16 (20.6)	5800 (399)
3/4	3/4	-WG-FO12-FL12	2.14 (54.4)	0.96 (24.4)	0.62 (15.7)	1 1/2 (38.1)	1 1/16 (27.0)	4000 (275)
1	1	-WG-FO16-FL16	2.45 (62.2)	1.23 (31.2)	0.87 (22.1)	1 3/4 (44.5)	1 3/8 (34.9)	3000 (206)

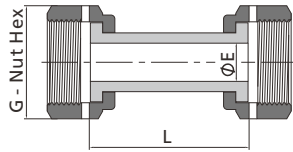

FO Welded Gland Union

FO Size (in.)	Basic Ordering Number	Dimensions, in. (mm)			Working Pressure psig (bar)
		L	E	G	
1/4	-WG-FO4	1.42 (36.1)	0.18 (4.6)	11/16 (17.5)	10200 (702)
1/2	-WG-FO8	1.61 (40.9)	0.40 (10.2)	1 (25.4)	5800 (399)

Nuts

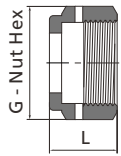

Female				
FO Size (in.)	Basic Ordering Number	Dimensions, in. (mm)		
		L	G	
1/8-1/4	-N-FO4	0.66 (16.8)	11/16 (17.5)	
3/8-1/2	-N-FO8	0.69 (17.5)	1 (25.4)	
3/4	-N-FO12	0.81 (20.6)	1 1/2 (38.1)	
1	-N-FO16	0.81 (20.6)	1 3/4 (44.5)	

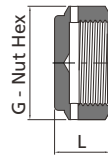

Blind				
FO Size (in.)	Basic Ordering Number	Dimensions, in. (mm)		
		L	G	
1/8-1/4	-N-FO4-B	0.44 (11.2)	11/16 (17.5)	
3/8-1/2	-N-FO8-B	0.56 (14.2)	1 (25.4)	
3/4	-N-FO12-B	0.75 (19.1)	1 1/2 (38.1)	
1	-N-FO16-B	0.81 (20.6)	1 3/4 (44.5)	

Bodies

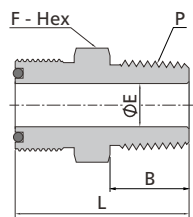

FO Body to Male NPT							
FO Size (in.)	P-NPT Size	Basic Ordering Number	Dimensions, in. (mm)				Working Pressure psig (bar)
			L	F	B	E	
1/4	1/8	-CM-FO4-NS2	1.16 (29.5)	5/8 (15.9)	0.38 (9.7)	0.18 (4.6)	10000 (689)
1/4	1/4	-CM-FO4-NS4	1.34 (34.0)	5/8 (15.9)	0.56 (14.2)	0.18 (4.6)	13400 (923)
1/2	3/8	-CM-FO8-NS6	1.46 (37.1)	15/16 (23.8)	0.56 (14.2)	0.38 (9.7)	7800 (537)
1/2	1/2	-CM-FO8-NS8	1.65 (41.9)	15/16 (23.8)	0.75 (19.1)	0.40 (10.2)	10000 (689)
3/4	3/4	-CM-FO12-NS12	1.75 (44.5)	1 5/16 (33.3)	0.75 (19.1)	0.62 (15.7)	7300 (502)
1	1	-CM-FO16-NS16	1.97 (50.0)	1 5/8 (41.3)	0.94 (23.9)	0.87 (22.1)	5300 (365)

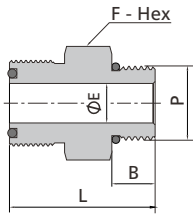

FO Body to SAE/MS Thread							
FO Size (in.)	P-SAE/MS Thread Size	Basic Ordering Number	Dimensions, in. (mm)				Working Pressure psig (bar)
			L	F	B	E	
1/4	7/16-20	-CM-FO4-ST7	1.24 (31.5)	11/16 (17.5)	0.36 (9.1)	0.18 (4.6)	4500 (310)
1/4	9/16-18	-CM-FO4-ST9	1.17 (29.7)	11/16 (17.5)	0.39 (9.9)	0.18 (4.6)	4500 (310)
1/2	7/16-20	-CM-FO8-ST7	1.36 (34.5)	15/16 (23.8)	0.36 (9.1)	0.18 (4.6)	4500 (310)
1/2	9/16-18	-CM-FO8-ST9	1.39 (35.3)	15/16 (23.8)	0.39 (9.9)	0.30 (7.6)	4500 (310)
1/2	3/4-16	-CM-FO8-ST12	1.47 (37.3)	1 (25.4)	0.44 (11.2)	0.40 (10.2)	4500 (310)
3/4	1 1/16-12	-CM-FO12-ST17	1.73 (43.9)	1 3/8 (34.9)	0.59 (15.0)	0.62 (15.7)	3600 (248)
1	1 5/16-12	-CM-FO16-ST21	1.79 (45.5)	1 5/8 (41.3)	0.59 (15.0)	0.85 (21.6)	2900 (199)

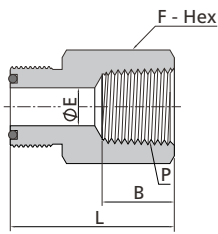

FO Body to Female NPT							
FO Size (in.)	P-NPT Size	Basic Ordering Number	Dimensions, in. (mm)				Working Pressure psig (bar)
			L	F	B	E	
1/4	1/8	-CF-FO4-NS2	1.25 (31.8)	5/8 (15.9)	0.41 (10.4)	0.18 (4.6)	8400 (578)
1/4	1/4	-CF-FO4-NS4	1.39 (35.3)	3/4 (19.1)	0.59 (15.0)	0.18 (4.6)	6600 (454)
1/2	3/8	-CF-FO8-NS6	1.57 (39.9)	15/16 (23.8)	0.59 (15.0)	0.40 (10.2)	6600 (454)
1/2	1/2	-CF-FO8-NS8	1.77 (45.0)	1 1/16 (27.0)	0.78 (19.8)	0.40 (10.2)	4900 (337)
3/4	3/4	-CF-FO12-NS12	1.93 (49.0)	1 5/16 (33.3)	0.81 (20.6)	0.62 (15.7)	4600 (316)
1	1	-CF-FO16-NS16	2.02 (51.3)	1 5/8 (41.3)	1.00 (25.4)	0.87 (22.1)	4400 (303)

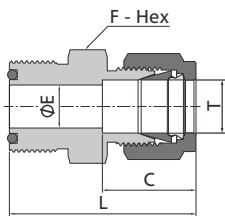

FO Body to Tube Fitting							
FO Size (in.)	T-tube O.D. (in.)	Basic Ordering Number	Dimensions, in. (mm)				Working Pressure psig (bar)
			L	F	C	E	
1/4	1/8	-U-FO4-FL2	1.38 (35.1)	5/8 (15.9)	0.51 (13.0)	0.09 (2.3)	10900 (751)
1/4	1/4	-U-FO4-FL4	1.47 (37.3)	5/8 (15.9)	0.60 (15.2)	0.18 (4.6)	10200 (702)
1/2	3/8	-U-FO8-FL6	1.65 (41.9)	15/16 (23.8)	0.66 (16.8)	0.28 (7.1)	6500 (447)
1/2	1/2	-U-FO8-FL8	1.78 (45.2)	15/16 (23.8)	0.90 (22.9)	0.40 (10.2)	6700 (461)
3/4	3/4	-U-FO12-FL12	1.86 (47.2)	1 5/16 (33.3)	0.96 (24.4)	0.62 (15.7)	5800 (399)
1	1	-U-FO16-FL16	2.06 (52.3)	1 5/8 (41.3)	1.23 (31.2)	0.87 (22.1)	4700 (323)

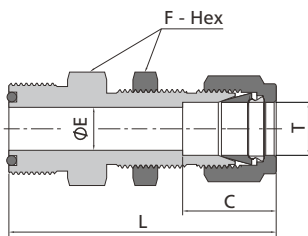

FO Body to Bulkhead Tube Fitting									
FO Size (in.)	T-tube O.D. (in.)	Basic Ordering Number	Dimensions, in. (mm)				Panel Hole Drill Size in. (mm)	Max. Panel Thickness in. (mm)	Working Pressure psig (bar)
			L	F	C	E			
1/4	1/4	-UB-FO4-FL4	2.10 (53.4)	5/8 (15.9)	0.60 (15.2)	0.18 (4.6)	0.45 (11.5)	0.40 (10.2)	10200 (702)
1/2	3/8	-UB-FO8-FL6	2.34 (59.4)	15/16 (23.8)	0.66 (16.8)	0.28 (7.1)	0.58 (14.7)	0.44 (11.2)	6500 (447)
1/2	1/2	-UB-FO8-FL8	2.55 (64.8)	15/16 (23.8)	0.90 (22.9)	0.40 (10.2)	0.76 (19.4)	0.50 (12.7)	6700 (461)
3/4	3/4	-UB-FO12-FL12	2.86 (72.6)	1 5/16 (33.3)	0.96 (24.4)	0.62 (15.7)	1.02 (25.8)	0.66 (16.8)	5800 (399)
1	1	-UB-FO16-FL16	3.29 (83.6)	1 5/8 (41.3)	1.23 (31.2)	0.87 (22.1)	1.33 (33.7)	0.75 (19.1)	4700 (323)

Fittings

Valves

Regulators

Filters

Tubing

Integrated Systems

Other Products

Technical Information

F-49 Face Seal Fittings

Fittings

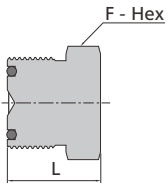

Blind Body			
FO Size (in.)	Basic Ordering Number	Dimensions, in. (mm)	
		L	F
1/4	-BY-FO4	0.77 (19.6)	5/8 (15.9)
1/2	-BY-FO8	0.89 (22.6)	15/16 (23.8)
3/4	-BY-FO12	0.99 (25.1)	1 5/16 (33.3)
1	-BY-FO16	1.02 (25.9)	1 5/8 (41.3)

Valves

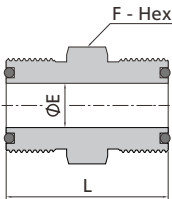

Union Body						
FO Size (in.)	FO Size (in.)	Basic Ordering Number	Dimensions, in. (mm)			Working Pressure psig (bar)
			L	F	E	
1/4	1/4	-U-FO4	1.25 (31.8)	5/8 (15.9)	0.18 (4.6)	14300 (985)
1/2	1/4	-U-FO8-FO4	1.43 (36.3)	15/16 (23.8)	0.18 (4.6)	11100 (764)
1/2	1/2	-U-FO8	1.50 (38.1)	15/16 (23.8)	0.40 (10.2)	11100 (764)

Regulators

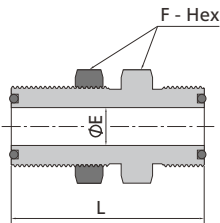

Bulkhead Union Body							
FO Size (in.)	Basic Ordering Number	Dimensions, in. (mm)			Panel Hole Drill Size in. (mm)	Max. Panel Thickness in. (mm)	Working Pressure psig (bar)
		L	F	E			
1/4	-BU-FO4	1.88 (47.8)	3/4 (19.1)	0.18 (4.6)	0.58 (14.7)	0.36 (9.1)	14300 (985)
1/2	-BU-FO8	2.09 (53.1)	1 1/16 (27.0)	0.40 (10.2)	0.89 (22.6)	0.40 (10.2)	11100 (764)

Filters

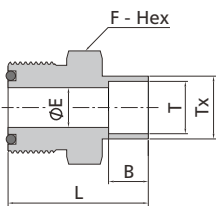

Tubing

FO Body to Tube Socket Weld								
FO Size (in.)	T-Tube O.D. (in.)	Basic Ordering Number	Dimensions, in. (mm)					Working Pressure psig (bar)
			L	F	E	B	Tx	
1/8	1/8	-CW-FO2-TS2	0.88 (22.4)	5/8 (15.9)	0.09 (2.3)	0.10 (2.5)	0.29 (7.4)	12600 (868)
1/4	1/4	-CW-FO4-TS4	1.09 (27.7)	5/8 (15.9)	0.18 (4.6)	0.28 (7.1)	0.38 (9.7)	6800 (468)
3/8	3/8	-CW-FO6-TS6	1.28 (32.5)	15/16 (23.8)	0.28 (7.1)	0.31 (7.9)	0.60 (15.2)	8100 (558)
1/2	1/2	-CW-FO8-TS8	1.34 (34.0)	15/16 (23.8)	0.40 (10.2)	0.38 (9.7)	0.60 (15.2)	3000 (206)
3/4	3/4	-CW-FO12-TS12	1.50 (38.1)	1 5/16 (33.3)	0.62 (15.7)	0.44 (11.2)	0.92 (23.4)	3700 (254)
1	1	-CW-FO16-TS16	1.72 (43.7)	1 5/8 (41.3)	0.87 (22.1)	0.62 (15.7)	1.19 (30.2)	3000 (206)

Integrated Systems

Other Products

Technical Information

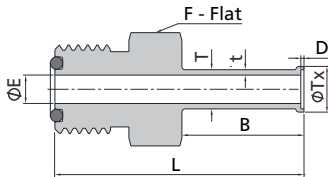

FO Body to Automatic Tube Weld

FO Size (in.)	T-tube O.D. (in.)	t-Wall Thickness (in.)	Basic Ordering Number	Dimensions, in. (mm)						Working Pressure psig (bar)
				L	B	D	E	Tx	F	
1/4	1/4	0.035	-CW-FO4-TB4A	1.59 (40.4)	0.78 (19.8)	0.02 (0.5)	0.18 (4.6)	0.29 (7.4)	5/8 (15.9)	5100 (351)
1/2	3/8	0.035	-CW-FO8-TB6A	1.74 (44.2)	0.79 (20.0)	0.03 (0.8)	0.31 (7.9)	0.41 (10.4)	15/16 (23.8)	3300 (227)
1/2	1/2	0.049	-CW-FO8-TB8A	1.75 (44.4)	0.80 (20.3)	0.04 (1.0)	0.40 (10.2)	0.55 (14.0)	15/16 (23.8)	3500 (241)
3/4	3/4	0.049	-CW-FO12-TB12A	1.78 (45.2)	0.80 (20.3)	0.04 (1.0)	0.65 (16.5)	0.80 (20.3)	1 5/16 (33.3)	2200 (151)
1	1	0.065	-CW-FO16-TB16A	2.03 (51.6)	1.00 (25.4)	0.04 (1.0)	0.87 (22.1)	1.06 (26.9)	1 5/8 (41.3)	2200 (151)

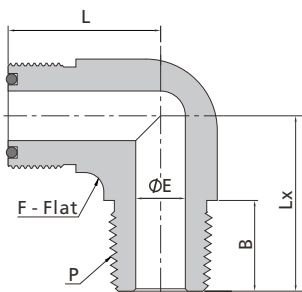

FO Body to Male NPT Elbow

FO Size (in.)	P-NPT Size	Basic Ordering Number	Dimensions, in. (mm)					Working Pressure psig (bar)
			L	F	B	E	Lx	
1/4	1/8	-LM-FO4-NS2	0.96 (24.4)	9/16 (14.3)	0.38 (9.7)	0.18 (4.6)	0.87 (22.1)	10000 (689)
1/4	1/4	-LM-FO4-NS4	0.96 (24.4)	9/16 (14.3)	0.56 (14.2)	0.18 (4.6)	1.05 (26.7)	8000 (551)
1/2	3/8	-LM-FO8-NS6	1.26 (32.0)	13/16 (20.6)	0.56 (14.2)	0.38 (9.7)	1.26 (32.0)	7800 (537)
1/2	1/2	-LM-FO8-NS8	1.26 (32.0)	13/16 (20.6)	0.75 (19.1)	0.40 (10.2)	1.45 (36.8)	7700 (530)
3/4	3/4	-LM-FO12-NS12	1.48 (37.6)	1 1/4 (31.8)	0.75 (19.1)	0.62 (15.7)	1.67 (42.4)	7300 (502)
1	1	-LM-FO16-NS16	1.56 (39.6)	1 11/16 (42.9)	0.94 (23.9)	0.87 (22.0)	1.94 (49.3)	5300 (365)

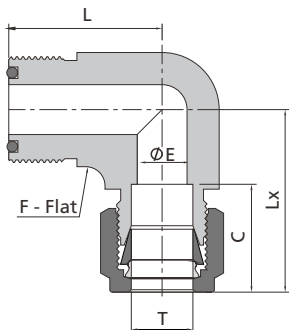

FO Body to Tube Fitting Elbow

FO Size (in.)	T-Tube O.D. (in.)	Basic Ordering Number	Dimensions, in. (mm)					Working Pressure psig (bar)
			L	F	C	E	Lx	
1/4	1/4	-LU-FO4-FL4	0.96 (24.4)	9/16 (14.3)	0.60 (15.2)	0.18 (4.6)	1.19 (30.2)	10200 (702)
1/2	3/8	-LU-FO8-FL6	1.26 (32.0)	13/16 (20.6)	0.66 (16.8)	0.28 (7.1)	1.39 (35.3)	6500 (447)
1/2	1/2	-LU-FO8-FL8	1.26 (32.0)	13/16 (20.6)	0.90 (22.9)	0.40 (10.2)	1.50 (38.1)	6700 (461)
3/4	3/4	-LU-FO12-FL12	1.48 (37.6)	1 1/4 (31.8)	0.96 (24.4)	0.62 (15.7)	1.80 (45.7)	5800 (399)
1	1	-LU-FO16-FL16	1.56 (39.6)	1 11/16 (42.9)	1.23 (31.2)	0.87 (22.1)	2.04 (51.8)	4700 (323)

Fittings

Valves

Regulators

Filters

Tubing

Integrated Systems

Other Products

Technical Information

F-51 Face Seal Fittings

Fittings

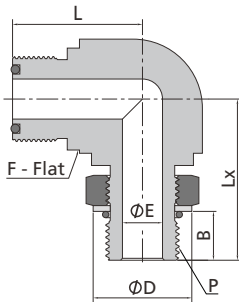

Valves

Regulators

Filters

Tubing

Integrated Systems

Other Products

Technical Information

FO Body to Male SAE/MS Thread Positionable Elbow

FO Size (in.)	P-SAE/MS Thread Size	Basic Ordering Number	Dimensions, in. (mm)						Working Pressure psig (bar)
			L	F	B	E	D	Lx	
1/4	7/16-20	-LP-FO4-ST7	0.96 (24.4)	1/2 (12.7)	0.39 (9.9)	0.18 (4.6)	0.65 (16.5)	1.19 (30.2)	4500 (310)
1/2	9/16-18	-LP-FO8-ST9	1.33 (33.8)	13/16 (20.6)	0.44 (11.2)	0.30 (7.6)	0.79 (20.1)	1.54 (39.1)	3600 (248)
1/2	3/4-16	-LP-FO8-ST12	1.33 (33.8)	13/16 (20.6)	0.50 (12.7)	0.40 (10.2)	1.01 (25.7)	1.65 (41.9)	3600 (248)
3/4	1 1/16-12	-LP-FO12-ST17	1.53 (38.9)	1 1/4 (31.8)	0.66 (16.8)	0.62 (15.7)	1.44 (36.6)	2.13 (54.1)	2900 (199)
1	1 5/16-12	-LP-FO16-ST21	1.72 (43.7)	1 11/16 (42.9)	0.66 (16.8)	0.87 (22.1)	1.73 (43.9)	2.31 (58.7)	2300 (158)

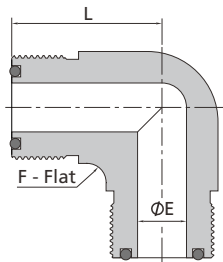

FO Body Union Elbow

FO Size (in.)	Basic Ordering Number	Dimensions, in. (mm)			Working Pressure psig (bar)
		L	F	E	
1/4	-LU-FO4	0.96 (24.4)	9/16 (14.3)	0.18 (4.6)	14300 (985)
1/2	-LU-FO8	1.26 (32.0)	13/16 (20.6)	0.40 (10.2)	11100 (764)
3/4	-LU-FO12	1.48 (37.6)	1 1/4 (31.8)	0.62 (15.7)	10900 (751)
1	-LU-FO16	1.56 (39.6)	1 11/16 (42.9)	0.87 (22.1)	8800 (606)

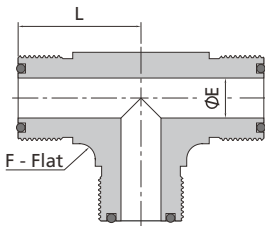

FO Body Union Tee

FO Size (in.)	Basic Ordering Number	Dimensions, in. (mm)			Working Pressure psig (bar)
		L	F	E	
1/4	-TTT-FO4	0.96 (24.4)	9/16 (14.3)	0.18 (4.6)	14300 (985)
1/2	-TTT-FO8	1.26 (32.0)	13/16 (20.6)	0.40 (10.2)	11100 (764)
3/4	-TTT-FO12	1.48 (37.6)	1 1/4 (31.8)	0.62 (15.7)	10900 (751)
1	-TTT-FO16	1.56 (39.6)	1 11/16 (42.9)	0.87 (22.1)	8800 (606)

O-Rings

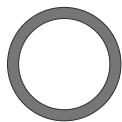

FO O-Ring

FO Size (in.)	Basic Ordering Number
1/8-1/4	-010
3/8-1/2	-111
3/4	-116
1	-215

Male SAE/MS O-Ring

P-SAE/MS Thread Size (in.)	Basic Ordering Number
7/16-20	-904
9/16-18	-906
3/4-16	-908
1 1/16-12	-912
1 5/16-12	-916

Add the overall designator for O-rings on page F-43 as a prefix to basic ordering number to get the complete ordering number. Example: VI7-010, VI9-904
For O-rings made from other materials, please contact FITOK.

Gaskets

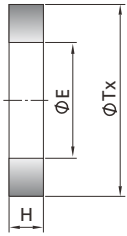

FO Gasket				
FO Size (in.)	Basic Ordering Number	Dimensions, in. (mm)		
		Tx	E	H
1/4	-GT-FO4	0.42 (10.6)	0.26 (6.5)	0.07 (1.7)
1/2	-GT-FO8	0.66 (16.8)	0.46 (11.6)	0.10 (2.5)

Add the designator for PTFE on page F-43 as a prefix to the basic ordering number to get the complete ordering number. Example: T-GT-FO4
For FO gaskets in other sizes, please contact FITOK.

Fittings

Valves

Regulators

Filters

Tubing

Integrated Systems

Other Products

Technical Information